

New River Valley News & Views

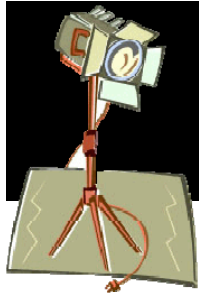

NEW RIVER VALLEY PLANNING DISTRICT COMMISSION

6580 Valley Center Drive, Suite 124, Radford, VA 24141
Ph: 540.639.9313 | Fax: 540.831.6093 | nrvpdc@nrvdc.org | www.nrvpdc.org



“go green NRV” in the Spotlight

The New River Valley PDC is

making strides in sustainability and supporting regional efforts to help other worksites do the same. The PDC is adopting a program for sustainability and green practices focused on its daily operations and office enterprise, with the assistance of **go green NRV**. The Commission also adopted the following environmental policy as part of its commitment to environmental sustainability: “The New River Valley Planning District Commission (NRVPDC) recognizes the value of ensuring the region’s continued quality of life, economic opportunity, and sustainable growth. The natural resources and healthy environment that exist in the New River Valley are also critical to the region’s success and worth preserving. To more fully serve the region’s local governments and their citizens, the NRVPDC commits to practicing environmental stewardship and leading by example through its operations, programs, and relationships. The goals of the policy are to conserve energy and resources, reduce costs and impacts to the environment, and encourage its members to adopt environmentally sustainable policies and practices.”

The NRVPDC, through its staff, will demonstrate its stewardship in practical and relevant ways via the following objectives:

- Reduce pollution and consumption of materials and energy in office operations through conservation practices and green purchasing.
- Make consideration of environmental concerns an integral part of planning and decision-making in all programs.
- Provide resources and training to staff to enable adoption of environmentally sound practices.
- Communicate with staff and stakeholders to implement and continually improve the environmental practices of the organization.
- Assist member localities in developing and quantifying green initiatives and practices in their organizations and communities.
- Conduct an annual assessment of the NRVPDC’s adherence to the policy and document the organization’s performance and progress based on objectives established the previous year.”

The PDC has catalogued existing sustainable practices and identified others that can

be instituted in the short and long-term. Progress is being made in reducing consumption, recycling, energy conservation, and sustainable purchasing.

To more fully achieve its green initiatives, the Commission is taking the opportunity to work with **go green NRV** and has applied to participate in their green business operations program. **go green NRV** is an organization focused on helping NRV businesses evaluate and institute green practices at their worksites. The **go green NRV** program also helps businesses track their progress, through annual reviews, in making their operations as sustainable as possible. The program also provides forums for sharing how other businesses in the New River Valley are becoming more environmentally sustainable.

More information about the organization, as well as how businesses can participate, is available at their website: www.gogreenrv.com. For more information, please contact Christy Straight or Regina Elsner, at (540) 639-9313 or cstraight@nrvdc.org, relsner@nrvdc.org.

Inside this issue:

NRVPDC UPDATES	2
NRVPDC COMMISSION MEETING SUMMARIES	3
NRV ECONOMIC INDICATORS	4
TRANSPORTATION NEWS	4
NRV HAZARD MITIGATION PLAN	4
CALENDARS	5
THE COMPETITIVE EDGE	Insert
RIDE SOLUTIONS	6

NRVPDC Commissioners

- **FLOYD COUNTY**
EVELYN JANNEY
FRED GERALD
- **GILES COUNTY**
RICHARD MCCOY
VACANT
- **MONTGOMERY COUNTY**
ANNETTE PERKINS
JAMES POLITIS
MIKE HARVEY
- **PULASKI COUNTY**
JOSEPH SHEFFEY
SHAWN UTT
- **CITY OF RADFORD**
HELEN HARVEY
THOMAS STARNES, CHAIR
- **TOWN OF BLACKSBURG**
DON LANGREHR
HOLLY LESKO
- **TOWN OF CHRISTIANSBURG**
HENRY SHOWALTER
SCOTT WEAVER, TREASURER
- **TOWN OF FLOYD**
MIKE PATTON
- **TOWN OF NARROWS**
TOM GARRETT
- **TOWN OF PEARISBURG**
REBECCA MOSES, VICE CHAIR
- **TOWN OF PULASKI**
JEFF BAIN
LARRY CLEVINGER
- **TOWN OF RICH CREEK**
DARLENE FRENCH
- **RADFORD UNIVERSITY**
VACANT
- **VIRGINIA TECH**
DAVID DENT
KEVIN SULLIVAN

KEVIN R. BYRD, AICP
EXECUTIVE DIRECTOR
kbyrd@nrvdc.org

NRVPDC Updates

Town of Pearisburg Local Planning Assistance

The Town of Pearisburg Zoning Ordinance update is in the final process of being formalized with textual changes being complete. Changes to the Zoning Map are currently being analyzed and are anticipated to be completed in March. A joint public hearing is scheduled for April 13th, 2010. The update to this ordinance and the Town of Pearisburg Subdivision Ordinance in 2008 include changes required by law and is in keeping with the Town Comprehensive Plan. Updates to the Zoning Ordinance specifically address issues related to land use and will provide additional opportunities to citizens, business owners, and property owners while keeping with the needs of the Town. It is anticipated that adoption will occur in the spring of 2010. For further information, please contact Jack Whitmore at (540) 639-9313, ext. 259.

Floyd County Comprehensive Plan Update

Floyd County is currently in the process of a Comprehensive Plan update. This update is being completed to reflect changes that have occurred in the County since the last adopted Comprehensive Plan (2002). Input sessions have begun and have included interested parties from local non-profit organizations, citizen groups, governmental organizations, and others with interest in the Plan. Additional focus group meetings are currently being scheduled with meetings focusing on elements of the Comprehensive Plan.

After the focus groups have determined specific issues and projects, it is anticipated that drafting of the Plan will begin and further community meetings will be held in different areas of the County to gain additional input from interested parties. Additionally, information gathering is ongoing and will provide the County with necessary tools and data to implement the Plan. For further information, please contact Jack Whitmore at (540) 639-9313, ext. 259.

Town of Floyd Comprehensive Plan

The Town of Floyd has begun the process of creating its Comprehensive Plan. Prior comprehensive planning was included with the Floyd County Comprehensive Plan. The Town Plan will augment the County Comprehensive Plan but will also serve as a standalone document. This Plan will provide the Town with the necessary data and implementation strategies to continue to provide necessary services and data for

decisions involving future land use, transportation, economic development, housing, and other needs. Once data has been assembled, the Town will be able to proceed with community input sessions to help refine the Plan into an implementation tool for future decision making. For further information, please contact Jack Whitmore at (540) 639-9313, ext. 259.

Disability Services Board (DSB)

At its next quarterly meeting, the Disability Services Board will be taking time to participate in another project administered by the PDC. The New River Valley Hazard Mitigation Plan is currently being updated, with the goal of alleviating some of the risks associated with certain natural hazards through mitigating measures. The DSB will be asked to give special insight as to the needs and risks for vulnerable populations. For further information, please contact Jennifer Wilsie at (540) 639-9313, ext. 204.

HOME

After nearly three years as a Consortium, HOME Consortium staff has compiled an informational presentation detailing an overview of the HOME program as well as a look at all the HOME projects completed to date. Staff will be giving this presentation at Town Councils and Boards of Supervisors meetings across the New River Valley. Thus far, the HOME Consortium has provided the funding for single-family rehab, new construction of single family and multi-family homes, and down payment assistance in Pulaski County, the City of Radford, the Town of Blacksburg, and Montgomery County. Giles County is currently in the planning phase for their upcoming funding rotation in 2011 and, this coming fiscal year, Floyd County will begin planning for their 2012 funding rotation. For further information, please contact Jennifer Wilsie at (540) 639-9313, ext. 204.

Pulaski County Housing Rehab

The PDC is nearing completion on its Community Development Block Grant, funded by the Department of Housing and Community Development (DHCD), for the Baskerville neighborhood in Pulaski County. Extensive surveying, data collection, mapping, income verification, and community input are involved in putting together a competitive application. The selected project area will be a candidate for housing rehabilitation, substantial reconstruction of nonrehabable homes, demolition of blighted structures, and water and sewer line improvements. There are 45 homes in the project area, with approximately 16 slated for rehabilitation work and 5 slated for substantial reconstruction. All beneficiaries must qualify at 80% of the

area median income or below to be eligible for the program. The completed grant is due to DHCD on March 31, 2010. For further information, please contact Jennifer Wilsie at (540) 639-9313, ext. 204.

Mobility Management

The PDC is currently administering a Mobility Management Grant under the Department of Rail and Public Transportation, with a scope that has primarily included extensive data collection and the drafting of a transit resource manual. Additionally, the PDC has applied for a Phase II Mobility Manager grant to partner with an existing human service agency and extend the position beyond the data collection component and into implementation in the region in order to address gaps in current service. Through the creation of a Mobility Specialist, and with the use of the Transportation Resource Manual created from the first phase of the PDC's Mobility Manager grant, a dedicated transit dispatcher will carry the dual role of intercepting calls and implementing educational outreach throughout the New River Valley. With a 1-800 number reserved for callers seeking information on transit (as well as an informative, interactive NRV RideConnect website option), the Mobility Specialist will be equipped to answer questions and help direct callers to the best transit option for their needs. For further information, please contact Jennifer Wilsie at (540) 639-9313, ext. 204.

Green Infrastructure

Since receiving the final draft mapping from the Conservation Management Institute at Virginia Tech, the NRVPDC has been busy updating the database and creating thematic overlays. Combining and cleaning up the drafts should be completed in the next couple of weeks. The Green Infrastructure steering committee will be meeting in early February to provide input on these maps.

Once the mapping is complete and a report is drafted, the communications sub-committee will work to identify and schedule meetings with local governing bodies, as well as interested community groups. The mapping and report will be provided to local governments for their use, if desired, in future decision-making processes. For further information, please contact Regina Elsner at (540) 639-9313, ext. 205.

Regional Water Supply Plan

The NRVPDC expects to receive its draft water supply plan back from DEQ by the end of February. Following this, the NRVPDC will set a committee meeting to go over the draft plan, as well as the proposed drought ordinance and allow the committee

final input on the plan. Then NRVPC staff will be meeting with localities to determine a timeline for adopting both the plan and a drought ordinance. For further information, please contact Regina Elsner at (540) 639-9313, ext. 205.

'Round the Mountain

'Round the Mountain (RTM), southwest Virginia's regional artisan network, is hard at work in the New River Valley. The nonprofit organization represents 19 counties and 4 cities, with the New River Valley serving as its northernmost boundary. Each county (or partner counties) is tasked with identifying their locality's artisans and farms to compile in an informational brochure. Floyd County has already completed its brochure, with Montgomery County's and Radford's/Pulaski's scheduled for production in April of 2010. More information on 'Round the Mountain and RTM membership can be found at its website: www.roundthemountain.org. For further information, please contact Jennifer Wilsie at (540) 639-9313, ext. 204.

New River/Mount Rogers

Workforce Investment Board (WIB)

The WIB achieved exemplary performance of the Workforce Investment Act 17 performance standards for the Program Year ending June 30, 2009. The achievement of exemplary performance qualifies the WIB to receive Incentive Funds beginning July 1, 2010.

Due to the high unemployment rates within the New River Valley and Mount Rogers area, the Workforce Investment Board has experienced an increase in customer requests for training and services. Due to this increase in demand, the WIB will be applying for Rapid Response funding from the State to meet this increase in demand. Additional Rapid Response funding will be used to pay for training and supportive services necessary for customers to be able to complete training and secure suitable employment.

Additionally, due to the tremendous success of the ARRA Youth program, the Workforce Investment Board will be requesting \$180,000 of ARRA Youth funds to provide Work Experience and Work Readiness activities to 85 out-of-school youth through March 31, 2010. This will bring the number of youth served using ARRA Youth funds up to a total of 415. Through December 31, 2009, 99 percent of ARRA Youth program funds had been expended. ARRA Youth Program Operators did an excellent job serving youth customers utilizing ARRA Youth funds. For further information, please contact Ronnie Martin at (540) 633-6764 or email rmartin@nrvc.org.

NRVPDC Commission Meeting Summaries

December 10, 2009

Transportation:

- Christiansburg kicked-off transit on Nov. 23rd
- Partnership with Town of Blacksburg/Blacksburg Transit
- Smartway fare increased from \$3 to \$4 one-way

Employment Mobility Study:

- Won NADO Innovation Award and NADO Excellence in Regional Transportation Award

Energy Grants:

- Virginia Department of Mines, Minerals and Energy Grant
- PDC's serve as grant program coordinators for non-entitlement communities
- \$9.2 million available of non-entitlement (Towns of Christiansburg and Floyd, City of Radford, Counties of Giles and Pulaski, and the PDC submitted applications)
- Regional Energy Plan application (all localities provided letters of support)

Tourism:

- Informal working committee representing chambers and local governments
- PDC prepared a grant to Virginia Tourism Corporation for a regional tourism website
- If funded, PDC asked to serve as fiscal agent
- All four counties and the City provided letters of support.

Rt. 114 Bridge Utility Agreement:

- Utility encasements in bridge abutments
- Participants: Pepper's Ferry WWTP, Pulaski County, Montgomery County PSA, B-C-VPI Water Authority
- PDC serving as pass through from localities to VDOT
- Construction in 2012, provided SYIP does not change

Regional Broadband:

- New River Network Wireless Authority Application to NTIA earned 2nd phase inquiry (Pro Forma, Environmental, System Design, 2 weeks)

January 28, 2010

Transportation:

- City of Radford applying to DRPT for public transit launch
- Potential service between City and Radford University
- Ridership in Christiansburg Transit expansion continues to increase

Mobility Manager

- Phase 2 application to DRPT due Feb.1
- Seeking funds to Implement Mobility Specialist
- Help connect rider with correct service provider
- Research Rural Provider Agreements for efficiency

Southwest Virginia Cultural Heritage Commission

- Conducting cultural asset inventory with 19 counties in SWVA

The Crooked Road

- Expanding service area to align with 19 counties in SWVA

Tourism

- Received 50% funding from VTC marketing leverage program

Presentation: Aric Bopp, New River Valley Economic Development Alliance

Presentation: NRV Home Consortium by Jennifer Wilsie of the NRVPC and Elisabeth Vogel of the Town of Blacksburg

NRVPDC Commission meetings are held on the fourth Thursday of every month, 6:00 p.m., at the New River Valley Competitiveness Center in Fairlawn. All meetings are open to the public.



NRV Economic Indicators

The NRV's 2nd quarter wage data for 2008 and 2009 shows a decrease in average employment of 2,239 (3.3%) persons. The weekly wage decreased (\$9) and the number of establishments increased (70 or 1.8%).

AVERAGE EMPLOYMENT		
Jurisdiction	2008 2nd Qtr	2009 2nd Qtr
Floyd County	2,911	2,912
Giles County	4,892	4,797
Montgomery County	39,895	40,230
Pulaski County	13,822	11,905
Radford City	6,588	6,025
NRVPDC	68,108	65,869

Source: Virginia Employment Commission.

AVERAGE WEEKLY WAGE		
Jurisdiction	2008 2nd Qtr	2009 2nd Qtr
Floyd County	\$471	\$475
Giles County	603	626
Montgomery County	656	658
Pulaski County	654	579
Radford City	722	740
NRVPDC	650	641

Source: Virginia Employment Commission.

AVERAGE ESTABLISHMENTS		
Jurisdiction	2008 2nd Qtr	2009 2nd Qtr
Floyd County	366	389
Giles County	361	369
Montgomery County	2,169	2,203
Pulaski County	728	735
Radford City	351	349
NRVPDC	3,975	4,045

Source: Virginia Employment Commission.



Important Dates

- ▶ **April 1, 2010**-National Census Day.
- ▶ **April - July 2010**-Census takers visit households that did not return a form by mail.
- ▶ **December 2010**-By law, the Census Bureau delivers population information to the President for apportionment.
- ▶ **March 2011**—By law, the Census Bureau completes delivery of redistricting data to states. Source: <http://2010.census.gov>.

NRV Transportation News

The Bikeway-Walkway and Technical Advisory Committees met on the 19th of January and elected new Chairpersons and Vice Chairpersons for the 2010 calendar year. The Bikeway-Walkway Committee's new Chairperson is Jamie R. MacLean, Development Planner for Montgomery County and the Vice Chairperson is Kim Steika, Landscape Architecture Project Coordinator for Community Design Assistance Center. Major topics of the January meeting included local trail project and activity updates, a review of typical easement language for trails, and evaluation of new policy statements to be incorporated into the Regions Bikeway-Walkway-Blueway Plan.

The Transportation Technical Advisory Committee voted to keep the existing Chairperson Steve Sandy, Planning Director for Montgomery County and Vice Chairperson Roy Saville, Director of Facilities Planning and Construction for Radford University for the 2010 calendar year. Major topics of interest included an update on the Radford Transit Study, and an introduction into the Rural Long-Range Plan (RLRP) technical document.

On the evening of January 25th Radford City Council voted to support a resolution that will allow the City of Radford to apply for FY 2011 public transportation funds. Based on the transit survey feedback obtained from the City and University over 88% of respondents said they would support a new transit service and 65% said they would use a system if provided. If the grant is approved the City and University will begin a partnership to provide alternative transportation options for residents and students.

The Rural Long-Range Plan will be a detailed and thorough evaluation of existing roadways based on: mobility performance, safety and accidents, structure sufficiency, and travel forecasts through 2035. The plan will also analyze safety, congestion, public transportation, bicycle and pedestrian facilities, airports, goods movement, land use, future growth, and travel demand management. A technical report will be followed by a "consumer document" for the general public that showcases findings and evaluates potential solutions to the transportation network.

The New River Valley Planning District Commission would like to thank the 2009 Bikeway-Walkway Committee and Technical Advisory Committee members for their participation. The diverse range of membership on both of these committees continues to provide a regional forum for planning the future of transportation in the region.

For further information on transportation related issues, please contact Elijah Sharp at (540) 639-9313, ext. 210.

New River Valley Hazard Mitigation Plan

The Hazard Mitigation steering committee last met in November to hear from David Clarke of VDOT on landfall/sinkhole issues and Phil Hysell of the National Weather Service on severe weather in the NRV. The steering committee took a break during the months of December and January. The group will be meeting in February to discuss mitigation goals and strategies for specific hazards.

The NRVPDC has been working to update and improve the Hazard Mitigation website. This can be found at www.nrvpdc.org/HazardMitigation/HazardMitigationPlanning.html. Please feel free to take a look at the information provided and keep coming back as the site will be updated as work progresses on the draft of the plan. There is a portion of the site devoted to public input. Once the plan is drafted, this will provide residents in the region, as well as interested individuals outside the region, an opportunity to formally comment on the plan. For further information on Hazard Mitigation, please contact Christy Straight at cstraight@nrvdc.org or Regina Elsner at relsner@nrvdc.org or by phone at (540) 639-9313.

February 2010

SUN	MON	TUE	WED	THU	FRI	SAT
	1	2	3	4	5	6
7	8	9	10	11	12	13
14	15	16	17	18	19	20
21	22	23	24	25	26	27
28						

Meetings

- Feb. 2-Blacksburg PC-7:30 p.m.
- Feb. 4-MPO Policy Board Meeting-MC Gov't Center-2 p.m.
- Feb. 8-Pulaski Town PC-6 p.m.; Pearisburg PC- 7 p.m.
- Feb. 9-Pulaski PC-7 p.m.
- Feb. 10-Montgomery PC-7 p.m.
- Feb. 15-Radford PC-7 p.m.
- Feb. 16-Floyd PC-7p.m.
- Feb. 17-Montgomery PC-7 p.m.
- Feb. 18-MPO TAC-MC Gov't Center-10 a.m.
- Feb. 23-Giles PC-6:30 p.m.; Hazard Mitigation Mtg.-NRVPDC-9 a.m.
- Feb. 25-NRVPDC Commission Mtg.-6 p.m.

March 2010

SUN	MON	TUE	WED	THU	FRI	SAT
	1	2	3	4	5	6
7	8	9	10	11	12	13
14	15	16	17	18	19	20
21	22	23	24	25	26	27
28	29	30	31			

Meetings

- March 2-Blacksburg PC-7:30 p.m.
- March 4-MPO Policy Board Meeting-MC Gov't Center-2 p.m.
- March 8-Pulaski Town PC-6 p.m.; Pearisburg PC- 7 p.m.
- March 9-Pulaski PC-7 p.m.
- March 10-Montgomery PC-7 p.m.; NRV Commerce Park-Noon
- March 15-Radford PC-7 p.m.
- March 16-BWWW Mtg-NRVPDC-11:30 a.m.; TAC Mtg-NRVPDC-1:30 p.m.; Floyd PC-7p.m.;
- March 17-Montgomery PC-7 p.m.
- March 18-MPO TAC-MC Gov't Center-10 a.m.
- March 23-Giles PC-6:30 p.m.; Hazard Mitigation Mtg.-NRVPDC-9 a.m.
- March 25-NRVPDC Commission Mtg.-6 p.m.

THE COMPETITIVE EDGE

Official Publication of the New River Valley Competitiveness Center
A Small Business Incubator

Shawn Utt/Doug Hudson,
Acting Incubator Managers

February – March 2010

The ‘WOW’ Factor: Where Service Excellence Starts

Due to its popularity and effectiveness, New River Community College is offering the ‘WOW’ Factor customer service training for businesses in the New River Valley. Since customer service is vital to the success of any business, this is certainly an important opportunity. Sponsored by the Community College’s Office of Workforce Development and the Virginia Tourism Corporation (VTC), the workshop will be held on Wednesday, February 24th in Room 117 of Edwards Hall beginning at 10 a.m. and running until noon. Bobbie Walker, Director of Education and Workforce Readiness with the VTC, will lead participants toward positive behaviors that enhance customer service skills and help give employees confidence and the support needed to shine. To register, visit www2.nr.edu/wd_service/.

NRV Competitiveness Center Updates

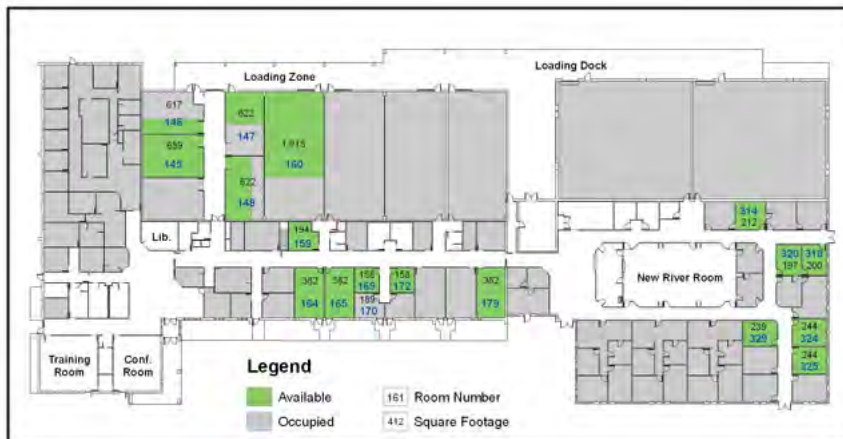

In a sign of a turning economy, the NRV Competitiveness Center occupancy is up to approximately 82%, but space is still available.

Currently, there are only 12 offices and a small amount of manufacturing space available. If you are interested in viewing the available space, visit the Center’s website at: www.nrvdc.org/nrvcc.html and click on “Floor Plan”.

ANNOUNCEMENTS

BAE Systems

BAE Systems cordially invites you to an Open House to learn more about their company and operations in the region. The Open House will be on Tuesday, February 23rd from 3 p.m. to 9 p.m. at The Inn at Virginia Tech, 901 Prices Fork Road in Blacksburg. For further information, contact Tony Hewitt at tony.hewitt@baesystems.com.

Competitiveness Center Tenant Survey Results and Implementation

Recently, the tenants of the Competitiveness Center were asked to take a short survey focusing on their needs as a small business and how the Competitiveness Center can meet those needs. The results will help the Center develop a set of training workshops geared toward meeting those needs. However, these workshops will also be open to all small businesses and those who may be interested in beginning a small business. If you are interested, please complete the survey on the next page and forward it to the Center by February 21st. Keep an eye out for updates and other happenings as they are planned.

Competitiveness Center Business Development Survey

The Management of the New River Valley Competitiveness Center would like to offer business development/support workshops to the tenants of the Center. Please take a few minutes to complete this survey to allow us a better idea of the current needs of the tenants.

All responses will remain completely anonymous.

1) Are you interested in participating in business development/support workshops?

- Yes
- No

2) To what extent do these content areas interest you?

Please use the 'Additional Comments' field to type other content areas you would like to have included in a professional development offering.

	Not interested	Somewhat interested	Very interested
Managing Credit & Debt	<input type="radio"/>	<input type="radio"/>	<input type="radio"/>
Business Start-up Basics	<input type="radio"/>	<input type="radio"/>	<input type="radio"/>
Writing a Business Plan	<input type="radio"/>	<input type="radio"/>	<input type="radio"/>
Marketing / Networking	<input type="radio"/>	<input type="radio"/>	<input type="radio"/>
Legal Considerations	<input type="radio"/>	<input type="radio"/>	<input type="radio"/>
Financial Record Keeping	<input type="radio"/>	<input type="radio"/>	<input type="radio"/>
"Meet the Lender"- A How-to Guide	<input type="radio"/>	<input type="radio"/>	<input type="radio"/>
Business Taxes	<input type="radio"/>	<input type="radio"/>	<input type="radio"/>
Technology and E-Commerce	<input type="radio"/>	<input type="radio"/>	<input type="radio"/>
	<input type="radio"/>	<input type="radio"/>	<input type="radio"/>

Additional Comments/Ideas for Workshops: _____

***** Thank you very much for your feedback and participation. *****

Please return the survey to the Center Manager’s office before February 21st in order to better allow for workshop coordination.

Questions or comments: Shawn Utt (sutt@pulaskicounty.org) or 540-980-7710

For Competitiveness Center information contact:
 Shawn Utt or Doug Hudson, Acting Incubator Managers
 6580 Valley Center Drive, Suite 302, Radford, VA 24141
 Phone: (540) 633-6730 Fax: (540) 633-6768
incubatormanager@nrvc.org or www.nrvc.org/nrvcc.html



New River Valley Planning District Commission
 6580 Valley Center Drive, Suite 124
 Radford, VA 24141

BULK RATE
 U.S. POSTAGE
 PAID
 RADFORD, VA
 PERMIT NO. 35

RIDE Solutions: Put your Commute to Work

.....
 Jan R. Gilbertson, Newsletter Editor
jan.nrvpdc@nrpdc.org

Driving alone to work? Don't. Put your commute to work for you - carpool with a coworker to share the cost of gas; walk or bicycle and get in your daily workout; or take the bus and use your commute time to plan your day, read the newspaper, or listen to your iPod. And when you register with RIDE Solutions for the free Guaranteed Ride Home benefit, you'll never worry about being stuck without a ride, missing the bus, or being caught in a storm. RIDE Solutions can help you save time and money by

connecting you to your commuting options with our FREE carpool matching service. To find out exactly how much you could save, go to the RIDE Solutions website and use the Ride Solver calculator: www.ridesolutions.org/ridesolver.asp.

Get your employer involved too! Businesses benefit when employees share the ride to work – a smaller carbon footprint, employee satisfaction at saving on the money it takes to get to work, reduced parking demand, and more. We'll

help them get the word out to your co-workers with promotional materials, contests, communication plans, even bike racks and signage, all free of charge. A complete list of RIDE Solutions Workplaces and more information about the Workplace program can be found at www.ridesolutions.org/workplace.

For more information, please contact Christy Straight, at (540) 639-9313, ext. 209 or cstraight@nrpdc.org.

*We're on
 the web at
nrpdc.org*

If you would like to receive this newsletter electronically, please email nrpdc@nrpdc.org.

