



**NEW RIVER VALLEY
PLANNING DISTRICT
COMMISSION**

6580 Valley Center Drive
Suite 124
Radford, VA 24141

Phone: 540.639.9313
Fax: 540.831.6093

nrvpdc@nrvdc.org

We're on the web!
www.nrvpdc.org

Inside this issue:

NRVPDC Updates	2
RIDE Solutions	3
NRVPDC Commission Meeting Summary	3
NRV Economic Indicators	4
U.S. Census 2010	4
Transportation News	4
Calendars for December 2009 and January 2010	5
NRV Competitiveness Center	Insert
New River Valley Hazard Mitigation Plan	6

New River Valley News & Views

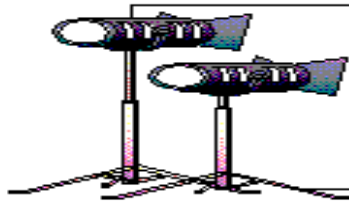

“2010 NRV Bikeway-Walkway-Blueway Plan” in the Spotlight

The 2010 New River Valley Bikeway-Walkway-Blueway Plan update is underway! This is the region's first plan update in ten years and will provide the groundwork for future alternative transportation planning. The purpose of updating the plan is to provide local governments and organizations with a long range regional plan that reflects the infrastructure built since the last plan and also identifies new policies and corridors to pursue in the coming years. This plan update will incorporate transit; park and ride areas; employment and high growth centers;

connections for schools with residences, social, commercial and historical points of interest; and promote recreation and tourism through the development of a viable multimodal transportation system. Developing a plan that creates safe and efficient bicycle and pedestrian options will lead to a reduction in vehicle miles travelled. The result is less traffic on local corridors and numerous benefits for the environment, personal health and the region's economy.

A recent study performed by the Rails-to-Trails Conservancy “Active Transportation for America” shows that over half of the trips in America can be completed within a twenty minute bike ride and a quarter can be completed within a twenty minute walk. Currently, just 9.6% of these short trips are taken by bicycling or walking. Automobiles account for approximately 20% of the total

U.S. carbon emissions. If pedestrian traffic frequency increased slightly over three percent to nearly thirteen percent, the total mileage of automobiles would be reduced by 69 billion miles. This reduction in vehicle miles equates to a reduction of 33 million tons of carbon per year.

In addition to environmental and personal health improvements, there are significant economic benefits for families and communities. Trails consistently increase property values along their corridors and are among the top amenities sought out by homebuyers. Further, trails also provide safe places for children to play that are free of motorized traffic. Bicycle and pedestrian infrastructure also provides an active transportation option for the elderly, disabled populations, and low income groups. Lastly, local businesses located along trail corridors experience a tremendous benefit from bicycle tourists visiting their community. For example, along the Virginia Creeper Trail in southwest Virginia, visitors spend an average of 1.6 million dollars annually, providing nearly thirty (30) full time jobs.

Recently, PDC staff has focused on developing quality mapping products which illustrate existing bicycle and pedestrian assets across the region. Some new mapping features include full color regional and jurisdictional maps, access labels designating each facilities use, NED topographical base maps to illustrate changes in elevation, legends depicting existing and proposed alignment names, detailed local aerial maps, and color coded permitted uses for each alignment. PDC staff is currently scheduling meetings with local governments in the region to update the existing database of facilities and incorporate future projects as identified by each jurisdiction.

Once complete, the maps will be an important tool for communities in their efforts to secure grant funding and garner public support for their projects.

In an effort to make the updated plan as accessible as possible, the PDC is developing an interactive web-based application that will contain policy statements supporting new projects and maps illustrating the initiatives. These policies and maps will be in a downloadable format that can be utilized by local governments and other organizations in grant applications or planning documents. The plan update is scheduled to be completed by July of 2010.

If you have transportation related improvement ideas for the region or have questions about transportation planning initiatives please contact: *Elijah Sharp* at 540-639-9313 ext. 210 or esharp@nrvdc.org.



NRVPDC Updates

Town of Floyd Comprehensive Plan

The Town of Floyd recently began the process of creating a Comprehensive Plan. Previously the Town's Plan was incorporated into the Floyd County Comprehensive Plan. To best support the community, it was decided by Town leaders to create a separate plan that would remain a chapter of the Floyd County's Comprehensive Plan but can be a standalone document.

Since this is the first Comprehensive Plan that the Town has compiled, specific elements are still being researched to provide the community with a vision that will be of maximum benefit. Specific elements being reviewed currently involve the demographics and economy of the Town. The Plan is scheduled to be completed in late 2010. For further information, please contact Jack Whitmore, at (540) 639-9313, ext. 259.

Town of Pearisburg Local Planning Assistance

The Town of Pearisburg is updating its Zoning Ordinance to better comply with the Code of Virginia and provide an updated approach to the zoning districts and uses in the Town. Reviews of the zoning districts have been formalized and additional Use determinations will be made at future Planning Commission meetings. In addition, a preliminary GIS based zoning map has been drafted and will be edited to better correspond with current zoning and any proposed changes to parcels in Town. It is estimated the update to the Ordinance will be completed in early 2010, with corrections to the zoning map being the final step prior to public hearings. For further information, please contact Jack Whitmore at (540) 639-9313, ext. 259.

Floyd County Comprehensive Plan Update

Floyd County is currently in the process of a Comprehensive Plan Update. This Update is being completed to reflect changes that have occurred in the County since the last adopted Comprehensive Plan (2002). Citizen groups and stakeholders are currently being identified and meetings with these groups to determine the strategies of the Comprehensive Plan are being formulated. These meetings will provide input to better shape future development in

the County, and also provide additional information in all areas of the Comprehensive Plan. For further information, please contact Jack Whitmore at (540) 639-9313, ext. 259.

Green Infrastructure

In October a small group of volunteers met to discuss a communications plan for the New River Valley Green Infrastructure Initiative. With limited resources, it is necessary to examine how best to engage community members and leaders in the green infrastructure process. Once the assessment is complete, the NRVPDC will be working to distribute and promote this as a resource for communities.

In November, the NRVPDC received the final report and data from the Conservation Management Institute at Virginia Tech. This report and data outline the base network for regional green infrastructure and contributing working lands. There is still more work to finalize the mapping, including finishing some data updates, as well as developing thematic overlays for water resources, cultural resources, recreation, natural hazards, and habitat diversity. When completed, these maps and overlays will form the foundation of a Green Infrastructure Assessment. For further information, please contact Regina Elsner at (540) 639-9313, ext. 205.

Pulaski County Housing Rehab

Pulaski County is hard at work, pulling together all the necessary components for its Community Development Block Grant (CDBG) due at the end of March 2010. The selected project area, the Baskerville neighborhood outside of Dublin, will be a candidate for housing rehabilitation, substantial reconstruction of nonhabitable homes, demolition of blighted structures, and water and sewer line improvements. Currently being conducted are housing estimates, applications for income eligibility, and a preliminary engineering report. This project will also be leveraged with funds from the HOME Consortium. For further information, please contact Jennifer Wilsie at (540) 639-9313, ext. 204.

HOME Consortium

The HOME Consortium has continued to move forward on its ongoing projects. In the City of Radford, the downtown mixed-use rental project is nearly ready for the lease of its eight one-bedroom apartments. The Town of Pulaski is under contract with DHCD on its Comprehensive Community project to provide homeowner rehab, infill

new construction and infrastructure.

Construction is slated to begin in January of 2010. Pulaski County is currently drafting its grant application, due March 31 of 2010, to DHCD for the Baskerville Neighborhood near Dublin. In Blacksburg, construction is nearly complete on 10 new construction infill homes in the Cedar Hill neighborhood, while Montgomery County is working on a rental rehabilitation project of 84 units in the Old Farm Village complex. Finally, Giles County has begun work on a Planning Grant in the Town of Rich Creek. For information, please contact Jennifer Wilsie at (540) 639-9313, ext. 204.

Disability Services Board

The New River Valley Disability Services Board (NRVDSB) met on Wednesday, November 18, 2009. The Board assessed its progress on several advocacy issues and discussed updates to its current website. The Board hopes to bring the NRVDSB website into more prominence, including updated contact information, accessibility to an ongoing Needs Assessment Survey, and highlighting relevant seminars, events, and conferences. The DSB's next quarterly meeting will take place on February 10, 2010. For further information, please contact Jennifer Wilsie at (540) 639-9313, ext. 204.

'Round the Mountain

'Round the Mountain (RTM), southwest Virginia's regional artisan network, is hard at work in the New River Valley. The nonprofit organization represents 19 counties and 4 cities, with the New River Valley serving as its northernmost boundary. Each county (or partner counties) is tasked with identifying their local artisans and farms to compile in an informational brochure. Floyd County has already completed its brochure, with Montgomery County's and Radford/Pulaski's scheduled for production in April of 2010. More information on 'Round the Mountain and RTM membership can be found at its website: www.roundthemountain.org. For further information, please contact Jennifer Wilsie at (540) 639-9313, ext. 204.

Mobility Management

Data collection is currently underway on the Mobility Management Grant, awarded by the Department of Rail and Public Transportation. During this 12-month grant, the PDC will gather extensive data on transportation providers in the New River Valley for the purpose of creating a working "resource manual." This manual will serve as the basis for a future "hub" of transit

information, connecting those looking for transportation, to the correct provider for their needs. For further information, please contact Jennifer Wilsie at (540) 639-9313, ext. 204.



NRVPDC Commission Meeting Summary

October 22, 2009

Energy Efficiency and Conservation Block Grant Program

The deadline for this grant program passed on November 6, 2009. Several localities in the New River Region took advantage of this program to apply for funds to improve their own energy efficiency. All PDC reviews have been completed as of November 13th and have been forwarded to the Virginia Department of Mines, Minerals, and Energy for grant award determination. Award decisions are expected sometime in December or shortly after January 1st. For further information, please contact Regina Elsner at (540) 639-9313, ext. 205.

New River/Mount Rogers Workforce Investment Board (WIB)

The New River/Mount Rogers Workforce Investment Board, utilizing American Recovery and Reinvestment Act (ARRA) funding has achieved the following positive program outcomes through September 30, 2009:

Funds Expended:	\$900,000
Customers Served:	733
DLW	350
Customers	55
Youth	328
Active Customers:	439
Participating in Occupational	
Skills Training:	338
Work Experience:	345
Work Readiness Instruction:	328
New Jobs Created:	62

It is projected that an additional 38 new jobs will be created before December 31, 2009 making the total new jobs created 100.

The ARRA program has been very successful in stimulating the local economy and positive results are projected for all currently active customers. ARRA funding will be available through the end of 2010. For further information, please contact Ronnie Martin at (540) 633-6764.

RIDE Solutions welcomes two new partners to their Workplace program — Draper Aden Associates and Baker Hughes. Their leadership in recognizing the benefits of commute options available in the region contributes to cost-savings for their staff, improved air quality, and reduced energy consumption. The benefit to the employer is reduced parking demand, free employee benefits, and a smaller carbon footprint.

Through its Workplace Partner program, RIDE Solutions assists area businesses and organizations with implementing employer-based alternative transportation programs. Working directly with businesses has two impacts on traffic in the region: 1) RIDE Solutions can more easily educate employees about the cost-savings and environmental benefits of commuting options other than the single-occupant vehicle (SOV) even as little as one day a week and 2) RIDE Solutions reaches an audience with a common destination or employment center, improving their opportunity to find matches for carpooling.

RIDE Solutions also supports its employer partners with promotional materials, contests, communication plans, even bike racks and signage, all free of charge. A complete list of RIDE Solutions Workplaces and more information about the Workplace program can be found at www.ridesolutions.org/workplace. For more information, please contact Christy Straight, at (540) 639-9313, ext. 209 or cstraight@nrfdc.org.

- **Regional Tourism:** Started last spring with a Pulaski Chamber branding effort; however it was realized a regional approach was the way to go due to location of attractions and accommodations. There was a meeting held in June with chambers and some in local government to discuss a Tourism website. Giles County prepared framework for a website and was revealed at an October meeting at the Shelor Motor Mile Speedway. Representatives from all counties are participating. There is a need to consider how tourism may or may not fit within one of the existing regional organizations.
- **Energy Grants:** Stimulus funds are available from the Department of Mines, Minerals and Energy (DMME) for local energy projects. The PDC is serving as grant program coordinator in the region. The PDC hosted a "How to Apply" workshop on Friday, October 16, and expect several applications to be submitted. The PDC is applying for funds for a Regional Energy Plan and will potentially partner with VT.
- **Proposed PDC Staff Support to Pulaski County:** Pulaski County has contracted with the PDC for staff support to the New River Valley Competitiveness Center. Services include bookkeeping, room reservations, opening/closing of doors, receiving packages for tenants, telecommunications support, notary services, and limited facility maintenance support.

The next Commission meeting will be held December 10, 2009, 6:00 p.m. at the New River Valley Competitiveness Center in Fairlawn with a holiday reception beginning at 5:30 p.m. All meetings are open to the public.



NRV Economic Indicators

Labor Force and Unemployment

All NRV jurisdictions experienced increases in their labor force between the 1st and 2nd quarters of 2009. In addition, four NRV jurisdictions experienced increases in their unemployment rate with Floyd County remaining steady at 8.2%.

AGGREGATE LABOR FORCE		
Jurisdiction	1st Qtr 2009	2nd Qtr 2009
Floyd County	21,801	22,058
Giles County	25,645	25,745
Montgomery County	137,428	138,108
Pulaski County	56,106	56,849
Radford City	24,196	24,590
New River Valley	265,176	267,350

Source: Virginia Employment Commission.

AVERAGE UNEMPLOYMENT RATE		
Jurisdiction	1st Qtr 2009	2nd Qtr 2009
Floyd County	8.2%	8.2%
Giles County	9.6%	9.7%
Montgomery County	7.0%	7.2%
Pulaski County	11.1%	12.0%
Radford City	8.3%	9.5%
New River Valley	8.4%	8.8%

Source: Virginia Employment Commission.



The 2010 Census questionnaire will be one of the shortest in history, consisting of 10 questions and taking about 10 minutes to complete. The questionnaire asks only a few simple questions of each person—name, relationship, gender, age and date of birth, race, and whether the respondent owns or rents his or her home. It takes just a few minutes to complete and return by mail. The 2010 Census is different from previous census efforts as in the last census, one in six households received a long questionnaire asking for detailed socioeconomic information. In 2010, every residence will receive a short questionnaire. More detailed information will be collected annually from a small percentage of the population through the American Community Survey. In March 2010, Census forms will be mailed or delivered to households and April 1, 2010 is considered National Census day. This day is used as a reference for sending your completed forms back in the mail. *Source: U.S. Census Bureau: <http://2010.census.gov>.*

Transportation News

The Bikeway-Walkway and Technical Advisory Committees met on the 17th of November and discussed the Town of Blacksburg's improvements to bicycle accommodations, the progress of the Region's Bikeway-Walkway-Blueway Plan, the City of Radford transit study currently underway, the Town of Christiansburg transit service creation, and Rural Long-Range Plan status.

On October 20th the PDC hosted Mr. Dana Martin, the Salem District Representative to the Commonwealth Transportation Board, for a series of meetings with applicants seeking Transportation Enhancement grant funding. This year's event marked the fourth consecutive year. With several Transportation Enhancement projects underway throughout the region and many more being proposed this year, hopefully positive funding news will be received in July of 2010. The New River Valley Bikeway-Walkway-Blueway Plan Update is moving towards the forefront of the Bikeway-Walkway Committee and the PDC will begin soliciting input from local governments and organizations to include projects completed over the last 10 years along with those identified for the next 10-20 years. The ultimate goal is to promote active transportation throughout the region while providing the tools needed to secure funding and support for projects from conceptualization to construction.

VDOT's consultant has recently completed traffic counts for the Rural Long-Range Plan and is currently working on draft recommendations for problematic intersections. In December the plans will be submitted to VDOT for a 30 day review. Immediately following, the Planning District Commission's Rural Transportation Committee will have the opportunity to provide feedback within 30 days.

A public hearing was held on December 1st in Richmond to revise the FY 2010 – 2015 Six-Year-Improvement-Plan (SYIP). For further information on transportation issues, please contact Eli Sharp at (540) 639-9313, ext. 210.

*Season's Greetings
From the
New River Valley
Planning District Commission*



December 2009

SUN	MON	TUE	WED	THU	FRI	SAT
		1	2	3	4	5
6	7	8	9	10	11	12
13	14	15	16	17	18	19
20	21	22	23	24	25 	26
27	28	29	30	31		

Meetings

- Dec. 1-Blacksburg PC-7:30 p.m.
- Dec. 8-Pulaski PC-7 p.m.
- Dec. 9-Montgomery PC-7 p.m.;
- Dec. 10-NRVPDC Commission Mtg.-6 p.m.
- Dec. 14-Pulaski Town PC-6 p.m.; Pearisburg PC- 7 p.m.
- Dec. 15-Floyd PC-7p.m.
- Dec. 16-Montgomery PC-7 p.m.
- Dec. 17-MPO TAC-MC Gov't Center-10 a.m.
- Dec. 21-Radford PC-7 p.m.
- Dec. 22-Giles PC-6:30 p.m.

January 2010

SUN	MON	TUE	WED	THU	FRI	SAT
					1 	2
3	4	5	6	7	8	9
10	11	12	13	14	15	16
17	18	19	20	21	22	23
24/31	25	26	27	28	29	30

Meetings

- Jan. 5-Blacksburg PC-7:30 p.m.
- Jan. 7-MPO Policy Board-MC Gov't Center-2 p.m.
- Jan. 11-Pulaski Town PC-6 p.m.
- Jan. 12-Pulaski PC-7 p.m.
- Jan. 13-Montgomery PC- 7 p.m.; Virginia's First-4:30 p.m.
- Jan. 19-BWVWV Mtg.-NRVPDC- 11:30 a.m.; TAC Mtg.-NRVPDC- 1:30 p.m.; Floyd PC-7 p.m.
- Jan. 20-Montgomery PC- 7 p.m.
- Jan. 21-MPO TAC-MC Gov't Center-10 a.m.
- Jan. 26-Giles PC-6:30 p.m.; Hazard Mitigation Mtg.-NRVPDC -9 a.m.
- Jan. 28-NRVPDC Commission Mtg.-6 p.m.

THE COMPETITIVE EDGE

Official Publication of the New River Valley Competitiveness Center

A Small Business Incubator

*Shawn Utt/Doug Hudson,
Acting Incubator Managers*

December 2009 – January 2010

NRV Competitiveness Center Transitions to New Management

With the retirement of Dave Rundgren as Executive Director of the New River Valley Development Corporation (see the newsletter from October 2009 for the announcement), the Development Corporation's Board of Directors has partnered with the County of Pulaski and its staff to assist in the management of the Competitiveness Center. The transition has been underway for two months and the County staff along with the Development Corporation's Board look forward to a positive relationship as we all work to make the Center a first-class business incubator. There are some exciting programs on the horizon for small businesses (new or existing), so be on the lookout.

NRV Competitiveness Center Welcomes New Tenants

Communicate Consulting

Communicate Consulting helps businesses and non-profits increase their profits and build long-term relationships through strategic marketing and precise communication. What that means is they help you find the right words and images to tailor your message, and combine them with the right places and times to get in front of your target audiences. If you're going to say something, say it right the first time. That's why they tailor each message to the people you're trying to reach, and then follow-up by measuring the results. That way you know exactly what you're getting for your money and time.

Their services include:

- Marketing strategy and planning
- Graphic design
- Advertising strategy in all media
- Web design and development
- Market research and survey design
- Event planning and strategy
- Public relations and media campaigns
- Staff training and presentations
- Public speaking training

Ready to start getting your message out? Visit their website at www.communicateconsulting.com or contact them at 540.267.3404.

MACO TOOL

MACO TOOL, INC. is a forward thinking company with small shop values.

Maco Tool is a precision machining and fabrication facility located in Christiansburg, VA and they have now added a second location at the Competitiveness Center. Their staff are trained professionals as evidenced by the precision workmanship and quality that go into each project. They also maintain a commitment to continually update their equipment, utilizing the latest computers, precision CNC machining technology, and a COORDINATE MEASURING MACHINE for inspection. MTI has become a major supplier for many well-known companies such as Federal Mogul, Bucyrus International and Volvo, with tooling and machines throughout the entire world. Please feel free to call 540.382.1871,

fax 540.382.1296, or e-mail fredcecil@macotool.com or edcampbell@macotool.com with your quote today. For further information, please visit <http://www.macotool.com>.

BAE Systems

BAE Systems is delighted to locate a Radford Field Office in the New River Valley Competitiveness Center. BAE Systems is a global, defense, security and aerospace company looking to further consolidate its activities in Virginia. The office will be open for business at the start of the New Year and provide an excellent base from which to develop new business opportunities. BAE Systems delivers a full range of products and services for air, land and naval forces, as well as advanced electronics, security, information technology solutions and customer support services.

ANNOUNCEMENTS

VIRGINIA BIOSCIENCE BUSINESS ROUNDTABLE

Thursday, December 17, 2009, 1 - 5:15 p.m.

Free of Charge/Reception to Follow

Virginia BioTechnology Research Park
800 East Leigh Street
Richmond, Virginia 23219

Go to www.virginiabbr.org for more information and to RSVP.

4TH ANNUAL NEW RIVER VALLEY CAREER FAIR: (Sponsored by Cumulus Broadcasting)

January 28, 2010, 10 a.m. - 6 p.m., at New River Valley Mall

To become an exhibitor or for further information, contact Judy Woodyard at Cumulus Media
(540) 731-6046 or (540) 577-5758.

Congratulations to the New River Valley Economic Development Alliance for being awarded "**Top 5 Website Design**" from Expansion Solutions Magazine, a national publication designed to inform key site selection consultants and corporate real estate brokers about progressive communities and the benefits that are offered by each community. See the Press Release at:
http://www.nrvalliance.org/news/documents/ESOL_Awards09PressRelease.pdf



For Competitiveness Center information contact:
Shawn Utt or Doug Hudson, Acting Incubator Managers
6580 Valley Center Drive, Suite 302, Radford, VA 24141
Phone: (540) 633-6730 Fax: (540) 633-6768
incubatormanager@nrvc.org or www.nrvdc.org/nrvcc.html



New River Valley Planning District Commission
 6580 Valley Center Drive, Suite 124
 Radford, VA 24141

**BULK RATE
 U.S. POSTAGE
 PAID
 RADFORD, VA
 PERMIT NO. 35**

.....
 NRVPMC Member Jurisdictions

Counties of Floyd, Giles, Montgomery,
 Pulaski, and the City of Radford

Towns of Blacksburg, Christiansburg,
 Floyd, Narrows, Pearisburg, Pulaski,
 and Rich Creek

Radford University and Virginia Tech

.....
 Kevin R. Byrd, Executive Director
 Jan R. Gilbertson, Newsletter Editor

**If you would like to
 receive this
 newsletter
 electronically,
 please email
 nrpdc@nrpdc.org**

New River Valley Hazard Mitigation Plan

The Hazard Mitigation Steering Committee has been meeting monthly since June 2009. The committee has heard from several speakers, including Brad Wright from the Virginia Department of Forestry and Chuck VanAllman, the City Engineer for the City of Salem, on various hazards and their mitigation. At their November meeting, committee members heard from Phil Hysell of the National Weather Service and David Clarke from the Virginia Department of Transportation. Mr. Hysell spoke about severe weather in the New River Valley and Mr. Clarke discussed VDOT's response to slope failures and karst topography.

After the first of the year, the Hazard Mitigation Steering Committee will begin looking at the data gathered and prepared by Radford University for the project. At these meetings, steering committee members will be identifying mitigation goals and strategies across the region and in specific communities. A draft plan is expected in Spring 2010.

For further information on Hazard Mitigation, please contact Christy Straight at cstraight@nrpdc.org or Regina Elsner at relsner@nrpdc.org or by phone at (540) 639-9313.

New River Valley News & Views



NEW RIVER VALLEY PLANNING DISTRICT COMMISSION

6580 Valley Center Drive, Suite 124, Radford, VA 24141
Ph: 540.639.9313 | Fax: 540.831.6093 | nrvpdc@nrvdc.org | www.nrvpdc.org

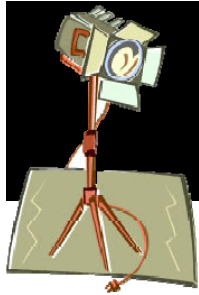

“go green NRV” in the Spotlight

The New River Valley PDC is

making strides in sustainability and supporting regional efforts to help other worksites do the same. The PDC is adopting a program for sustainability and green practices focused on its daily operations and office enterprise, with the assistance of **go green NRV**. The Commission also adopted the following environmental policy as part of its commitment to environmental sustainability: “The New River Valley Planning District Commission (NRVPDC) recognizes the value of ensuring the region’s continued quality of life, economic opportunity, and sustainable growth. The natural resources and healthy environment that exist in the New River Valley are also critical to the region’s success and worth preserving. To more fully serve the region’s local governments and their citizens, the NRVPDC commits to practicing environmental stewardship and leading by example through its operations, programs, and relationships. The goals of the policy are to conserve energy and resources, reduce costs and impacts to the environment, and encourage its members to adopt environmentally sustainable policies and practices.”

The NRVPDC, through its staff, will demonstrate its stewardship in practical and relevant ways via the following objectives:

- Reduce pollution and consumption of materials and energy in office operations through conservation practices and green purchasing.
- Make consideration of environmental concerns an integral part of planning and decision-making in all programs.
- Provide resources and training to staff to enable adoption of environmentally sound practices.
- Communicate with staff and stakeholders to implement and continually improve the environmental practices of the organization.
- Assist member localities in developing and quantifying green initiatives and practices in their organizations and communities.
- Conduct an annual assessment of the NRVPDC’s adherence to the policy and document the organization’s performance and progress based on objectives established the previous year.”

The PDC has catalogued existing sustainable practices and identified others that can

be instituted in the short and long-term. Progress is being made in reducing consumption, recycling, energy conservation, and sustainable purchasing.

To more fully achieve its green initiatives, the Commission is taking the opportunity to work with **go green NRV** and has applied to participate in their green business operations program. **go green NRV** is an organization focused on helping NRV businesses evaluate and institute green practices at their worksites. The **go green NRV** program also helps businesses track their progress, through annual reviews, in making their operations as sustainable as possible. The program also provides forums for sharing how other businesses in the New River Valley are becoming more environmentally sustainable.

More information about the organization, as well as how businesses can participate, is available at their website: www.gogreenrv.com. For more information, please contact Christy Straight or Regina Elsner, at (540) 639-9313 or cstraight@nrvdc.org, relsner@nrvdc.org.

Inside this issue:

NRVPDC UPDATES	2
NRVPDC COMMISSION MEETING SUMMARIES	3
NRV ECONOMIC INDICATORS	4
TRANSPORTATION NEWS	4
NRV HAZARD MITIGATION PLAN	4
CALENDARS	5
THE COMPETITIVE EDGE	Insert
RIDE SOLUTIONS	6

NRVPDC Commissioners

- **FLOYD COUNTY**
EVELYN JANNEY
FRED GERALD
- **GILES COUNTY**
RICHARD MCCOY
VACANT
- **MONTGOMERY COUNTY**
ANNETTE PERKINS
JAMES POLITIS
MIKE HARVEY
- **PULASKI COUNTY**
JOSEPH SHEFFEY
SHAWN UTT
- **CITY OF RADFORD**
HELEN HARVEY
THOMAS STARNES, CHAIR
- **TOWN OF BLACKSBURG**
DON LANGREHR
HOLLY LESKO
- **TOWN OF CHRISTIANSBURG**
HENRY SHOWALTER
SCOTT WEAVER, TREASURER
- **TOWN OF FLOYD**
MIKE PATTON
- **TOWN OF NARROWS**
TOM GARRETT
- **TOWN OF PEARISBURG**
REBECCA MOSES, VICE CHAIR
- **TOWN OF PULASKI**
JEFF BAIN
LARRY CLEVINGER
- **TOWN OF RICH CREEK**
DARLENE FRENCH
- **RADFORD UNIVERSITY**
VACANT
- **VIRGINIA TECH**
DAVID DENT
KEVIN SULLIVAN

KEVIN R. BYRD, AICP
EXECUTIVE DIRECTOR
kbyrd@nrvdc.org

NRVPDC Updates

Town of Pearisburg Local Planning Assistance

The Town of Pearisburg Zoning Ordinance update is in the final process of being formalized with textual changes being complete. Changes to the Zoning Map are currently being analyzed and are anticipated to be completed in March. A joint public hearing is scheduled for April 13th, 2010. The update to this ordinance and the Town of Pearisburg Subdivision Ordinance in 2008 include changes required by law and is in keeping with the Town Comprehensive Plan. Updates to the Zoning Ordinance specifically address issues related to land use and will provide additional opportunities to citizens, business owners, and property owners while keeping with the needs of the Town. It is anticipated that adoption will occur in the spring of 2010. For further information, please contact Jack Whitmore at (540) 639-9313, ext. 259.

Floyd County Comprehensive Plan Update

Floyd County is currently in the process of a Comprehensive Plan update. This update is being completed to reflect changes that have occurred in the County since the last adopted Comprehensive Plan (2002). Input sessions have begun and have included interested parties from local non-profit organizations, citizen groups, governmental organizations, and others with interest in the Plan. Additional focus group meetings are currently being scheduled with meetings focusing on elements of the Comprehensive Plan.

After the focus groups have determined specific issues and projects, it is anticipated that drafting of the Plan will begin and further community meetings will be held in different areas of the County to gain additional input from interested parties. Additionally, information gathering is ongoing and will provide the County with necessary tools and data to implement the Plan. For further information, please contact Jack Whitmore at (540) 639-9313, ext. 259.

Town of Floyd Comprehensive Plan

The Town of Floyd has begun the process of creating its Comprehensive Plan. Prior comprehensive planning was included with the Floyd County Comprehensive Plan. The Town Plan will augment the County Comprehensive Plan but will also serve as a standalone document. This Plan will provide the Town with the necessary data and implementation strategies to continue to provide necessary services and data for

decisions involving future land use, transportation, economic development, housing, and other needs. Once data has been assembled, the Town will be able to proceed with community input sessions to help refine the Plan into an implementation tool for future decision making. For further information, please contact Jack Whitmore at (540) 639-9313, ext. 259.

Disability Services Board (DSB)

At its next quarterly meeting, the Disability Services Board will be taking time to participate in another project administered by the PDC. The New River Valley Hazard Mitigation Plan is currently being updated, with the goal of alleviating some of the risks associated with certain natural hazards through mitigating measures. The DSB will be asked to give special insight as to the needs and risks for vulnerable populations. For further information, please contact Jennifer Wilsie at (540) 639-9313, ext. 204.

HOME

After nearly three years as a Consortium, HOME Consortium staff has compiled an informational presentation detailing an overview of the HOME program as well as a look at all the HOME projects completed to date. Staff will be giving this presentation at Town Councils and Boards of Supervisors meetings across the New River Valley. Thus far, the HOME Consortium has provided the funding for single-family rehab, new construction of single family and multi-family homes, and down payment assistance in Pulaski County, the City of Radford, the Town of Blacksburg, and Montgomery County. Giles County is currently in the planning phase for their upcoming funding rotation in 2011 and, this coming fiscal year, Floyd County will begin planning for their 2012 funding rotation. For further information, please contact Jennifer Wilsie at (540) 639-9313, ext. 204.

Pulaski County Housing Rehab

The PDC is nearing completion on its Community Development Block Grant, funded by the Department of Housing and Community Development (DHCD), for the Baskerville neighborhood in Pulaski County. Extensive surveying, data collection, mapping, income verification, and community input are involved in putting together a competitive application. The selected project area will be a candidate for housing rehabilitation, substantial reconstruction of nonrehabable homes, demolition of blighted structures, and water and sewer line improvements. There are 45 homes in the project area, with approximately 16 slated for rehabilitation work and 5 slated for substantial reconstruction. All beneficiaries must qualify at 80% of the

area median income or below to be eligible for the program. The completed grant is due to DHCD on March 31, 2010. For further information, please contact Jennifer Wilsie at (540) 639-9313, ext. 204.

Mobility Management

The PDC is currently administering a Mobility Management Grant under the Department of Rail and Public Transportation, with a scope that has primarily included extensive data collection and the drafting of a transit resource manual. Additionally, the PDC has applied for a Phase II Mobility Manager grant to partner with an existing human service agency and extend the position beyond the data collection component and into implementation in the region in order to address gaps in current service. Through the creation of a Mobility Specialist, and with the use of the Transportation Resource Manual created from the first phase of the PDC's Mobility Manager grant, a dedicated transit dispatcher will carry the dual role of intercepting calls and implementing educational outreach throughout the New River Valley. With a 1-800 number reserved for callers seeking information on transit (as well as an informative, interactive NRV RideConnect website option), the Mobility Specialist will be equipped to answer questions and help direct callers to the best transit option for their needs. For further information, please contact Jennifer Wilsie at (540) 639-9313, ext. 204.

Green Infrastructure

Since receiving the final draft mapping from the Conservation Management Institute at Virginia Tech, the NRVPDC has been busy updating the database and creating thematic overlays. Combining and cleaning up the drafts should be completed in the next couple of weeks. The Green Infrastructure steering committee will be meeting in early February to provide input on these maps.

Once the mapping is complete and a report is drafted, the communications sub-committee will work to identify and schedule meetings with local governing bodies, as well as interested community groups. The mapping and report will be provided to local governments for their use, if desired, in future decision-making processes. For further information, please contact Regina Elsner at (540) 639-9313, ext. 205.

Regional Water Supply Plan

The NRVPDC expects to receive its draft water supply plan back from DEQ by the end of February. Following this, the NRVPDC will set a committee meeting to go over the draft plan, as well as the proposed drought ordinance and allow the committee

final input on the plan. Then NRVPC staff will be meeting with localities to determine a timeline for adopting both the plan and a drought ordinance. For further information, please contact Regina Elsner at (540) 639-9313, ext. 205.

'Round the Mountain

'Round the Mountain (RTM), southwest Virginia's regional artisan network, is hard at work in the New River Valley. The nonprofit organization represents 19 counties and 4 cities, with the New River Valley serving as its northernmost boundary. Each county (or partner counties) is tasked with identifying their locality's artisans and farms to compile in an informational brochure. Floyd County has already completed its brochure, with Montgomery County's and Radford's/Pulaski's scheduled for production in April of 2010. More information on 'Round the Mountain and RTM membership can be found at its website: www.roundthemountain.org. For further information, please contact Jennifer Wilsie at (540) 639-9313, ext. 204.

New River/Mount Rogers

Workforce Investment Board (WIB)

The WIB achieved exemplary performance of the Workforce Investment Act 17 performance standards for the Program Year ending June 30, 2009. The achievement of exemplary performance qualifies the WIB to receive Incentive Funds beginning July 1, 2010.

Due to the high unemployment rates within the New River Valley and Mount Rogers area, the Workforce Investment Board has experienced an increase in customer requests for training and services. Due to this increase in demand, the WIB will be applying for Rapid Response funding from the State to meet this increase in demand. Additional Rapid Response funding will be used to pay for training and supportive services necessary for customers to be able to complete training and secure suitable employment.

Additionally, due to the tremendous success of the ARRA Youth program, the Workforce Investment Board will be requesting \$180,000 of ARRA Youth funds to provide Work Experience and Work Readiness activities to 85 out-of-school youth through March 31, 2010. This will bring the number of youth served using ARRA Youth funds up to a total of 415. Through December 31, 2009, 99 percent of ARRA Youth program funds had been expended. ARRA Youth Program Operators did an excellent job serving youth customers utilizing ARRA Youth funds. For further information, please contact Ronnie Martin at (540) 633-6764 or email rmartin@nrvc.org.

NRVPDC Commission Meeting Summaries

December 10, 2009

Transportation:

- Christiansburg kicked-off transit on Nov. 23rd
- Partnership with Town of Blacksburg/Blacksburg Transit
- Smartway fare increased from \$3 to \$4 one-way

Employment Mobility Study:

- Won NADO Innovation Award and NADO Excellence in Regional Transportation Award

Energy Grants:

- Virginia Department of Mines, Minerals and Energy Grant
- PDC's serve as grant program coordinators for non-entitlement communities
- \$9.2 million available of non-entitlement (Towns of Christiansburg and Floyd, City of Radford, Counties of Giles and Pulaski, and the PDC submitted applications)
- Regional Energy Plan application (all localities provided letters of support)

Tourism:

- Informal working committee representing chambers and local governments
- PDC prepared a grant to Virginia Tourism Corporation for a regional tourism website
- If funded, PDC asked to serve as fiscal agent
- All four counties and the City provided letters of support.

Rt. 114 Bridge Utility Agreement:

- Utility encasements in bridge abutments
- Participants: Pepper's Ferry WWTP, Pulaski County, Montgomery County PSA, B-C-VPI Water Authority
- PDC serving as pass through from localities to VDOT
- Construction in 2012, provided SYIP does not change

Regional Broadband:

- New River Network Wireless Authority Application to NTIA earned 2nd phase inquiry (Pro Forma, Environmental, System Design, 2 weeks)

January 28, 2010

Transportation:

- City of Radford applying to DRPT for public transit launch
- Potential service between City and Radford University
- Ridership in Christiansburg Transit expansion continues to increase

Mobility Manager

- Phase 2 application to DRPT due Feb.1
- Seeking funds to Implement Mobility Specialist
- Help connect rider with correct service provider
- Research Rural Provider Agreements for efficiency

Southwest Virginia Cultural Heritage Commission

- Conducting cultural asset inventory with 19 counties in SWVA

The Crooked Road

- Expanding service area to align with 19 counties in SWVA

Tourism

- Received 50% funding from VTC marketing leverage program

Presentation: Aric Bopp, New River Valley Economic Development Alliance

Presentation: NRV Home Consortium by Jennifer Wilsie of the NRVPC and Elisabeth Vogel of the Town of Blacksburg

NRVPDC Commission meetings are held on the fourth Thursday of every month, 6:00 p.m., at the New River Valley Competitiveness Center in Fairlawn. All meetings are open to the public.



NRV Economic Indicators

The NRV's 2nd quarter wage data for 2008 and 2009 shows a decrease in average employment of 2,239 (3.3%) persons. The weekly wage decreased (\$9) and the number of establishments increased (70 or 1.8%).

AVERAGE EMPLOYMENT		
Jurisdiction	2008 2nd Qtr	2009 2nd Qtr
Floyd County	2,911	2,912
Giles County	4,892	4,797
Montgomery County	39,895	40,230
Pulaski County	13,822	11,905
Radford City	6,588	6,025
NRVPDC	68,108	65,869

Source: Virginia Employment Commission.

AVERAGE WEEKLY WAGE		
Jurisdiction	2008 2nd Qtr	2009 2nd Qtr
Floyd County	\$471	\$475
Giles County	603	626
Montgomery County	656	658
Pulaski County	654	579
Radford City	722	740
NRVPDC	650	641

Source: Virginia Employment Commission.

AVERAGE ESTABLISHMENTS		
Jurisdiction	2008 2nd Qtr	2009 2nd Qtr
Floyd County	366	389
Giles County	361	369
Montgomery County	2,169	2,203
Pulaski County	728	735
Radford City	351	349
NRVPDC	3,975	4,045

Source: Virginia Employment Commission.



Important Dates

- ▶ **April 1, 2010**-National Census Day.
- ▶ **April - July 2010**-Census takers visit households that did not return a form by mail.
- ▶ **December 2010**-By law, the Census Bureau delivers population information to the President for apportionment.
- ▶ **March 2011**—By law, the Census Bureau completes delivery of redistricting data to states. Source: <http://2010.census.gov>.

NRV Transportation News

The Bikeway-Walkway and Technical Advisory Committees met on the 19th of January and elected new Chairpersons and Vice Chairpersons for the 2010 calendar year. The Bikeway-Walkway Committee's new Chairperson is Jamie R. MacLean, Development Planner for Montgomery County and the Vice Chairperson is Kim Steika, Landscape Architecture Project Coordinator for Community Design Assistance Center. Major topics of the January meeting included local trail project and activity updates, a review of typical easement language for trails, and evaluation of new policy statements to be incorporated into the Regions Bikeway-Walkway-Blueway Plan.

The Transportation Technical Advisory Committee voted to keep the existing Chairperson Steve Sandy, Planning Director for Montgomery County and Vice Chairperson Roy Saville, Director of Facilities Planning and Construction for Radford University for the 2010 calendar year. Major topics of interest included an update on the Radford Transit Study, and an introduction into the Rural Long-Range Plan (RLRP) technical document.

On the evening of January 25th Radford City Council voted to support a resolution that will allow the City of Radford to apply for FY 2011 public transportation funds. Based on the transit survey feedback obtained from the City and University over 88% of respondents said they would support a new transit service and 65% said they would use a system if provided. If the grant is approved the City and University will begin a partnership to provide alternative transportation options for residents and students.

The Rural Long-Range Plan will be a detailed and thorough evaluation of existing roadways based on: mobility performance, safety and accidents, structure sufficiency, and travel forecasts through 2035. The plan will also analyze safety, congestion, public transportation, bicycle and pedestrian facilities, airports, goods movement, land use, future growth, and travel demand management. A technical report will be followed by a "consumer document" for the general public that showcases findings and evaluates potential solutions to the transportation network.

The New River Valley Planning District Commission would like to thank the 2009 Bikeway-Walkway Committee and Technical Advisory Committee members for their participation. The diverse range of membership on both of these committees continues to provide a regional forum for planning the future of transportation in the region.

For further information on transportation related issues, please contact Elijah Sharp at (540) 639-9313, ext. 210.

New River Valley Hazard Mitigation Plan

The Hazard Mitigation steering committee last met in November to hear from David Clarke of VDOT on landfall/sinkhole issues and Phil Hysell of the National Weather Service on severe weather in the NRV. The steering committee took a break during the months of December and January. The group will be meeting in February to discuss mitigation goals and strategies for specific hazards.

The NRVPDC has been working to update and improve the Hazard Mitigation website. This can be found at www.nrvpdc.org/HazardMitigation/HazardMitigationPlanning.html. Please feel free to take a look at the information provided and keep coming back as the site will be updated as work progresses on the draft of the plan. There is a portion of the site devoted to public input. Once the plan is drafted, this will provide residents in the region, as well as interested individuals outside the region, an opportunity to formally comment on the plan. For further information on Hazard Mitigation, please contact Christy Straight at cstraight@nrvdc.org or Regina Elsner at relsner@nrvdc.org or by phone at (540) 639-9313.

February 2010

SUN	MON	TUE	WED	THU	FRI	SAT
	1	2	3	4	5	6
7	8	9	10	11	12	13
14	15	16	17	18	19	20
21	22	23	24	25	26	27
28						

Meetings

- Feb. 2-Blacksburg PC-7:30 p.m.
- Feb. 4-MPO Policy Board Meeting-MC Gov't Center-2 p.m.
- Feb. 8-Pulaski Town PC-6 p.m.; Pearisburg PC- 7 p.m.
- Feb. 9-Pulaski PC-7 p.m.
- Feb. 10-Montgomery PC-7 p.m.
- Feb. 15-Radford PC-7 p.m.
- Feb. 16-Floyd PC-7p.m.
- Feb. 17-Montgomery PC-7 p.m.
- Feb. 18-MPO TAC-MC Gov't Center-10 a.m.
- Feb. 23-Giles PC-6:30 p.m.; Hazard Mitigation Mtg.-NRVPDC-9 a.m.
- Feb. 25-NRVPDC Commission Mtg.-6 p.m.

March 2010

SUN	MON	TUE	WED	THU	FRI	SAT
	1	2	3	4	5	6
7	8	9	10	11	12	13
14	15	16	17	18	19	20
21	22	23	24	25	26	27
28	29	30	31			

Meetings

- March 2-Blacksburg PC-7:30 p.m.
- March 4-MPO Policy Board Meeting-MC Gov't Center-2 p.m.
- March 8-Pulaski Town PC-6 p.m.; Pearisburg PC- 7 p.m.
- March 9-Pulaski PC-7 p.m.
- March 10-Montgomery PC-7 p.m.; NRV Commerce Park-Noon
- March 15-Radford PC-7 p.m.
- March 16-BWWW Mtg-NRVPDC-11:30 a.m.; TAC Mtg-NRVPDC-1:30 p.m.; Floyd PC-7p.m.;
- March 17-Montgomery PC-7 p.m.
- March 18-MPO TAC-MC Gov't Center-10 a.m.
- March 23-Giles PC-6:30 p.m.; Hazard Mitigation Mtg.-NRVPDC-9 a.m.
- March 25-NRVPDC Commission Mtg.-6 p.m.

THE COMPETITIVE EDGE

Official Publication of the New River Valley Competitiveness Center
A Small Business Incubator

Shawn Utt/Doug Hudson,
Acting Incubator Managers

February – March 2010

The ‘WOW’ Factor: Where Service Excellence Starts

Due to its popularity and effectiveness, New River Community College is offering the ‘WOW’ Factor customer service training for businesses in the New River Valley. Since customer service is vital to the success of any business, this is certainly an important opportunity. Sponsored by the Community College’s Office of Workforce Development and the Virginia Tourism Corporation (VTC), the workshop will be held on Wednesday, February 24th in Room 117 of Edwards Hall beginning at 10 a.m. and running until noon. Bobbie Walker, Director of Education and Workforce Readiness with the VTC, will lead participants toward positive behaviors that enhance customer service skills and help give employees confidence and the support needed to shine. To register, visit www2.nr.edu/wd_service/.

NRV Competitiveness Center Updates

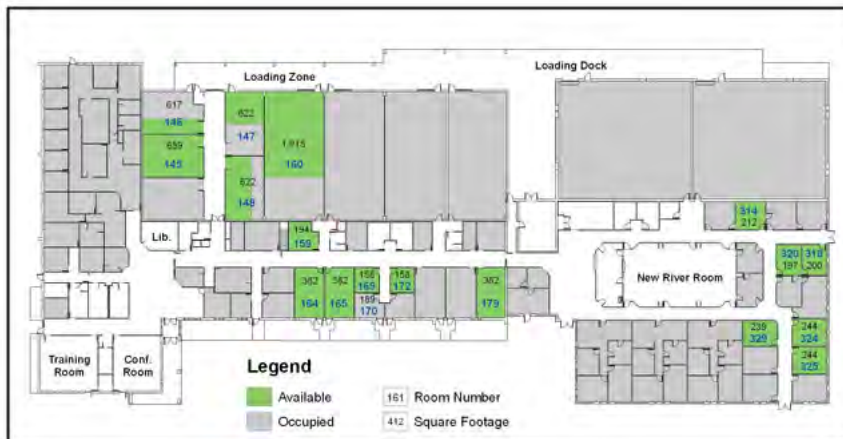

In a sign of a turning economy, the NRV Competitiveness Center occupancy is up to approximately 82%, but space is still available.

Currently, there are only 12 offices and a small amount of manufacturing space available. If you are interested in viewing the available space, visit the Center’s website at: www.nrvdc.org/nrvcc.html and click on “Floor Plan”.

ANNOUNCEMENTS

BAE Systems

BAE Systems cordially invites you to an Open House to learn more about their company and operations in the region. The Open House will be on Tuesday, February 23rd from 3 p.m. to 9 p.m. at The Inn at Virginia Tech, 901 Prices Fork Road in Blacksburg. For further information, contact Tony Hewitt at tony.hewitt@baesystems.com.

Competitiveness Center Tenant Survey Results and Implementation

Recently, the tenants of the Competitiveness Center were asked to take a short survey focusing on their needs as a small business and how the Competitiveness Center can meet those needs. The results will help the Center develop a set of training workshops geared toward meeting those needs. However, these workshops will also be open to all small businesses and those who may be interested in beginning a small business. If you are interested, please complete the survey on the next page and forward it to the Center by February 21st. Keep an eye out for updates and other happenings as they are planned.

Competitiveness Center Business Development Survey

The Management of the New River Valley Competitiveness Center would like to offer business development/support workshops to the tenants of the Center. Please take a few minutes to complete this survey to allow us a better idea of the current needs of the tenants.

All responses will remain completely anonymous.

1) Are you interested in participating in business development/support workshops?

- Yes
- No

2) To what extent do these content areas interest you?

Please use the 'Additional Comments' field to type other content areas you would like to have included in a professional development offering.

	Not interested	Somewhat interested	Very interested
Managing Credit & Debt	<input type="radio"/>	<input type="radio"/>	<input type="radio"/>
Business Start-up Basics	<input type="radio"/>	<input type="radio"/>	<input type="radio"/>
Writing a Business Plan	<input type="radio"/>	<input type="radio"/>	<input type="radio"/>
Marketing / Networking	<input type="radio"/>	<input type="radio"/>	<input type="radio"/>
Legal Considerations	<input type="radio"/>	<input type="radio"/>	<input type="radio"/>
Financial Record Keeping	<input type="radio"/>	<input type="radio"/>	<input type="radio"/>
"Meet the Lender"- A How-to Guide	<input type="radio"/>	<input type="radio"/>	<input type="radio"/>
Business Taxes	<input type="radio"/>	<input type="radio"/>	<input type="radio"/>
Technology and E-Commerce	<input type="radio"/>	<input type="radio"/>	<input type="radio"/>
	<input type="radio"/>	<input type="radio"/>	<input type="radio"/>

Additional Comments/Ideas for Workshops: _____

***** Thank you very much for your feedback and participation. *****

Please return the survey to the Center Manager’s office before February 21st in order to better allow for workshop coordination.

Questions or comments: Shawn Utt (sutt@pulaskicounty.org) or 540-980-7710

For Competitiveness Center information contact:
 Shawn Utt or Doug Hudson, Acting Incubator Managers
 6580 Valley Center Drive, Suite 302, Radford, VA 24141
 Phone: (540) 633-6730 Fax: (540) 633-6768
incubatormanager@nrvc.org or www.nrvc.org/nrvcc.html



New River Valley Planning District Commission
 6580 Valley Center Drive, Suite 124
 Radford, VA 24141

BULK RATE
 U.S. POSTAGE
 PAID
 RADFORD, VA
 PERMIT NO. 35

RIDE Solutions: Put your Commute to Work

•••••
 Jan R. Gilbertson, Newsletter Editor
jan.nrvpdc@nrpdc.org

Driving alone to work? Don't. Put your commute to work for you - carpool with a coworker to share the cost of gas; walk or bicycle and get in your daily workout; or take the bus and use your commute time to plan your day, read the newspaper, or listen to your iPod. And when you register with RIDE Solutions for the free Guaranteed Ride Home benefit, you'll never worry about being stuck without a ride, missing the bus, or being caught in a storm. RIDE Solutions can help you save time and money by

connecting you to your commuting options with our FREE carpool matching service. To find out exactly how much you could save, go to the RIDE Solutions website and use the Ride Solver calculator: www.ridesolutions.org/ridesolver.asp.

Get your employer involved too! Businesses benefit when employees share the ride to work – a smaller carbon footprint, employee satisfaction at saving on the money it takes to get to work, reduced parking demand, and more. We'll

help them get the word out to your co-workers with promotional materials, contests, communication plans, even bike racks and signage, all free of charge. A complete list of RIDE Solutions Workplaces and more information about the Workplace program can be found at www.ridesolutions.org/workplace.

For more information, please contact Christy Straight, at (540) 639-9313, ext. 209 or cstraight@nrpdc.org.

*We're on
 the web at
nrpdc.org*

If you would like to receive this newsletter electronically, please email nrpdc@nrpdc.org.



New River Valley News & Views



NEW RIVER VALLEY PLANNING DISTRICT COMMISSION

6580 Valley Center Drive, Suite 124, Radford, VA 24141
 Ph: 540.639.9313 | Fax: 540.831.6093 | nrvpdc@nrvc.org | www.nrvpdc.org

Inside this issue:

NRVPDC UPDATES	2
PLANNING COMMISSIONERS TRAINING SESSION	3
NRVPDC COMMISSION MEETING SUMMARIES	3
NRV ECONOMIC INDICATORS	4
TRANSPORTATION NEWS	4
U.S. CENSUS 2010	4
CALENDARS	5
THE COMPETITIVE EDGE	Insert
RIDE SOLUTIONS	6

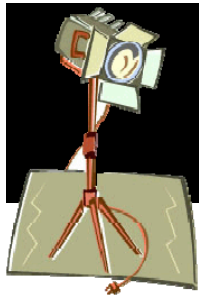

“Pulaski County Community Development Block Grant: Baskerville Neighborhood Rehab Project” in the Spotlight

The PDC has assisted Pulaski

County with its application for a Community Development Block Grant from the Department of Housing and Community Development (DHCD), a state agency whose priority is creating safe, affordable, and prosperous communities in Virginia. The Baskerville Neighborhood Rehabilitation Project area is located southwest of the Town of Dublin in Pulaski County, Virginia and proposes to provide housing rehabilitation, substantial reconstruction, and water and sewer line upgrades to the community.

The Baskerville Housing Rehabilitation Project was brought to the County’s attention during one of its annual CDBG public hearings geared toward receiving general comments from the citizens on potential needs. Representatives from the Peoples Community Partnership of Dublin spoke to the County’s Board of Supervisors during their January 2008 Board meeting and described the need for safe and sanitary housing in the Baskerville neighborhood. Shortly thereafter, the County applied to DHCD for a Planning Grant to help evaluate the area and define the needs to be addressed.

A thorough needs assessment revealed that many of the homes in the neighborhood are either stick built homes well over 50 years old or mobile homes that are in various states of disrepair. As the neighborhood’s population continues to age, the ability to continue suitable upkeep of property diminishes greatly. Out of the 39 dwellings located in the project area, two dwellings (5%) are vacant, two (5%) are rental units, and 35 (90%) are owner-occupied. Proposed project improvements include the rehabilitation of 11 income eligible, owner-occupied dwellings, the rehabilitation of one income eligible rental dwelling, and the substantial reconstruction of six income eligible owner-occupied dwellings deemed unsuitable for rehabilitation. It also includes the demolition of one vacant and blighted structure. Those homes slated for substantial reconstruction will involve the demolition of the existing structure and the construction of a new home in its place.

The project will also include a component of water and sewer line upgrades, to be designed by Draper Aden Associates.

The County has requested \$1,000,000 from DHCD for this project and will leverage \$47,000 in local funds, \$207,000 in HOME funds, \$25,000 from Southeast Rural

Community Assistance Program (SERCAP), \$180,000 in State HOME funds, and \$45,000 in State Weatherization funds available through Community Housing Partners, for a \$1,504,000 total project budget.

The County should be notified if its application has been funded by July of 2010. For further information, please contact Jennifer Wilsie at (540) 639-9313, ext. 204.



Pictured above: Potential Housing Rehabilitation Beneficiaries

NRVPDC Commissioners

- **FLOYD COUNTY**
EVELYN JANNEY
FRED GERALD
- **GILES COUNTY**
RICHARD MCCOY
VACANT
- **MONTGOMERY COUNTY**
ANNETTE PERKINS
JAMES POLITIS
MIKE HARVEY
- **PULASKI COUNTY**
JOSEPH SHEFFEY
SHAWN UTT
- **CITY OF RADFORD**
HELEN HARVEY
THOMAS STARNES, CHAIR
- **TOWN OF BLACKSBURG**
DON LANGREHR
HOLLY LESKO
- **TOWN OF CHRISTIANSBURG**
HENRY SHOWALTER
SCOTT WEAVER, TREASURER
- **TOWN OF FLOYD**
MIKE PATTON
- **TOWN OF NARROWS**
TOM GARRETT
- **TOWN OF PEARISBURG**
REBECCA MOSES, VICE CHAIR
- **TOWN OF PULASKI**
JEFF BAIN
LARRY CLEVINGER
- **TOWN OF RICH CREEK**
DARLENE FRENCH
- **RADFORD UNIVERSITY**
VACANT
- **VIRGINIA TECH**
DAVID DENT
KEVIN SULLIVAN

KEVIN R. BYRD, AICP
 EXECUTIVE DIRECTOR
 kbyrd@nrvc.org

NRVPDC Updates

Town of Pearisburg Local Planning Assistance

The Town of Pearisburg Zoning Ordinance update is in the final process of being formalized with text changes complete. Changes to the zoning map are currently being analyzed. A joint public hearing is scheduled for April 13th, 2010. The update to this ordinance and the Town of Pearisburg Subdivision Ordinance in 2008 include changes required by law and is in keeping with the Town Comprehensive Plan. Updates to the Zoning Ordinance specifically address issues related to land use and will provide additional opportunities to citizens, business owners, and property owners while keeping with the needs of the Town. *For further information, please contact Jack Whitmore at (540) 639-9313, ext. 259.*

Floyd County Comprehensive Plan Update

Floyd County is currently in the process of a Comprehensive Plan Update. This update is being completed to reflect changes that have occurred in the County since the last adopted Comprehensive Plan (2002). Focus groups have been held concerning agriculture, tourism planning, infrastructure, economic development, recreation, wellness, and solid waste management. Additional meetings will be held on these topics as well as public safety, housing, and human service issues in the County.

After the focus groups have identified specific issues and projects, it is anticipated that drafting of the Plan will begin and further community meetings will be held in different areas of the County to gain additional input from interested parties. Additional information gathering is ongoing and will provide the County with necessary tools and data to implement the Plan. *For further information, please contact Jack Whitmore at (540) 639-9313, ext. 259.*

Town of Floyd Comprehensive Plan

The Town of Floyd has begun the process of creating a Comprehensive Plan for the Town. Prior Comprehensive Planning for the Town was included with the Floyd County Comprehensive Plan. The Town Plan will augment the County Comprehensive Plan but will also serve as a standalone document. This Plan will

provide the Town with implementation strategies and data for decisions involving future land use, transportation, economic development, and housing. *For further information, please contact Jack Whitmore at (540) 639-9313, ext. 259.*

NRV HOME Consortium

Per HUD regulations, every three years, member jurisdictions in a HOME Consortium are required to renew their participation. In part, the HOME presentations given by Consortium staff over the past few months at Councils and Boards of Supervisors across the region have been to inform these governing bodies of the successes the Consortium has seen over the past three years and to encourage their continued participation. The work of the Consortium has been enthusiastically received and has served as a prominent example of regionalism at work in the New River Valley. *For further information, please contact Jennifer Wilsie at (540) 639-9313, ext. 204.*

Mobility Management

The New River Valley Planning District Commission (PDC) is currently administering a Mobility Management Grant under DRPT, whose scope has primarily included extensive data collection and the drafting of a regional transit resource manual. Data collection will continue over the next few months with drafting of the transit manual slated to begin before the end of the fiscal year. Regular stakeholder meetings will also be held to gain feedback from key transit providers. *For further information, please contact Jennifer Wilsie at (540) 639-9313, ext. 204.*

Green Infrastructure

Mapping for the Green Infrastructure project is mostly complete. Work is continuing on drafting a report that will provide useful information to member localities and be a valuable resource for other partner agencies.

In the coming months, the Green Infrastructure website will be revamped to include the network mapping, as well as all information gathered during this process. Please continue to check back for this information. *For further information, please contact Regina Elsner at (540) 639-9313, ext. 205.*

New River/Mount Rogers Workforce Investment Board (WIB)

The New River/Mount Rogers Workforce Investment Board recently received \$252,991 of Stimulus Dislocated Worker funds to provide much needed employment and training services to our displaced workers. Currently we are serving over 650 Dislocated Workers across our area.

The average unemployment rate for the New River/Mount Rogers Workforce Investment Area continues to be very high and consistently above the average for the state. Recently the average unemployment rate was 9% with several jurisdictions experiencing unemployment in excess of 10%. Additionally, many displaced workers are now available for services offered under the Trade Readjustment and Assistance Act. The Workforce Investment Board continues to partner with various agencies and organizations to increase the level of services available to our citizens while maximizing available resources. *For further information, please contact Ronnie Martin at (540) 633-6764 or email rmartin@nrvc.org.*

New River Valley Hazard Mitigation Plan

The Drought Hazard Working Group met in February to discuss data available for the hazard, as well as mitigation goals, objectives, and strategies related to drought. The Geologic Hazard Working Group met in March to discuss landslides and earthquakes. On April 27, the Geologic Hazard Working Group will be discussing rockfall and Karst. Additional working groups will be meeting on the following dates to discuss specific hazards: May 25-Severe Weather, June 29-Flooding, Dam Failure, July 27-Human-caused, Wildfire.

As sections of the plan are completed, they are posted at www.nrvc.org/HazardMitigation/HazardMitigationPlanning.html. Please continue to check back as the website will be updated regularly. *For further information on Hazard Mitigation, please contact Christy Straight at cstraight@nrvc.org or Regina Elsner at relsner@nrvc.org or by phone at (540) 639-9313.*

Planning Commissioners Training Session

The New River Valley Planning District Commission will hold a training session for planning commissioners and staff on April 28th at 6:00 p.m. at the New River Valley Competitiveness Center ([6580 Valley Center Drive](#), Radford VA) located in Fairlawn.

This year's session will focus on alternative energy and modern applications in residential development. The event will include a presentation by Pat Bixler, owner of Baseline Solar Solutions.

The agenda includes:

- Land Use Applications for New Energy Technologies-Overview of alternative energy sources from large scale, industrial wind turbines to alternative household approaches and how community regulations effect the application of these newer technologies.
- Planning Commission Exercise-A chance to work with Planning Commission members from similar jurisdictions in the region on an application-based workshop scenario.
- Open Forum-Your chance to ask questions for the good of the whole and hear the speaker's and staff opinions.

Tickets are \$13.50 and include a meal. It is requested that you **RSVP prior to April 19th**, to Jack Whitmore, jwhitmore@nrvc.org to ensure an accurate headcount.

This event was planned and coordinated by New River Valley staff planners via bi-monthly round table discussions. *For further information, please contact Jack Whitmore at (540) 639-9313, ext. 259.*

NRVPDC Commission Meeting Summaries

February 25, 2010

State Budget:

- House proposed 15% reduction
- Senate proposed elimination of PDC funding
- Call to Action: Explain PDC serves core function in State government
- Mayor Starnes made contact on behalf of NRVPDC
- Potential need to contact conferees Friday and Monday

Energy Grants:

- Governor formal announcement today or Friday
- Informally: City of Radford - \$23,000
- Feasibility Study for Bio-mass project

Economic Development Administration Grant:

- Community Trade Adjustment Assistance Program: Auto industry: Volvo and supply chain
- Potential application with VT Office of Economic Development, NRVPDC to be lead applicant
- Partnering with Roanoke & Mt. Rogers PDCs
- Marketing assistance from economic developers

VAPDC Winter Conference:

- Secretary of Commerce, Honorable Jim Chang
- Double Governor's Opportunity Fund (\$12 mil to \$24)
- Increase incentives for Film Industry
- Energy capital of east coast (off shore oil and wind turbines)
- Trade offices in China and India (\$1 mil for each office)
- Working to establish a Deputy Secretary for Rural VA

Regional Broadband:

- Announced VT Foundation received funding for "diversity line" from Bedford through Craig County.
- NRV Network Wireless Authority not funded, but working on an application for round 2. Revising pro-forma and potentially increasing service area.

March 25, 2010

State Budget:

- Conference Committee recommended 15% reduction in funds for PDCs (\$77,720 to \$66,062) down from 2007 funding of \$90,000
- 27% reduction in 3 years
- VAPDC Strategic Planning next week to address state funding in future

Regional Partnerships:

- County Administrators/Town Managers/Regional Agency Directors meet and discuss ways to work together to save funds, time and decrease duplication of resources
- Next meeting will focus on IT services

NRV Tourism Website:

- Grant from VA Tourism Corporation and local match
- Regional website "without borders" highlighting the green/cultural heritage experiences in the NRV
- RFP for website designer released on 3/23, sent to 6 local firms, bids are due April 19th
- Thanks to Montgomery County staff for RFP review

Local Planning Commissioner Training:

- April 19th, 6:00-9:00 p.m.
- Focus on alternative energy systems: Wind Turbines (small and large) and Solar
- PDC staff working on developing large wind energy system ordinance for localities

Presentation: Todd Christensen, Executive Director, Southwest Virginia Cultural Heritage Commission. Mr. Christensen presented slides showing the new Heartwood: Southwest Virginia's Artisan Gateway.

NRVPDC Commission meetings are held on the fourth Thursday of every month, 6:00 p.m. at the New River Valley Competitiveness Center in Fairlawn. All meetings are open to the public.



NRV Economic Indicators

Population

Provisional population estimates for 2009 show that the New River Valley increased in population (474 persons) from 2008. Montgomery County showed the largest increase (661 persons).

Jurisdiction	2009 Provisional Estimates	2008 Final
Floyd County	15,418	15,173
Giles County	16,648	16,444
Montgomery County	91,395	90,734
Pulaski County	34,167	34,409
Radford City	15,142	15,536
NRVPDC	172,770	172,296
Virginia	7,882,590	7,795,424

Source: Weldon Cooper Center for Public Service, UVA Demographics & Workforce Group, 2010.

Taxable Sales

The dollar amount of taxable sales decreased throughout most of the NRV jurisdictions between the 3rd and 4th quarters of 2009. Montgomery County showed the largest increase (\$4,440,892) with Pulaski County showing the largest decrease (\$5,715,989).

TAXABLE SALES		
Jurisdiction	2009 3rd Qtr	2009 4th Qtr
Floyd County	16,534,748	15,485,046
Giles County	32,801,674	30,470,817
Montgomery County	225,417,898	229,858,790
Pulaski County	77,051,153	71,335,164
Radford City	15,984,557	17,413,517

Source: Virginia Department of Taxation.

New Vehicle Registrations

Car and truck registrations decreased throughout the District between the 3rd and 4th quarters of 2009. Montgomery County showed the largest decrease in car registrations with Floyd County showing the largest decrease in truck registrations, 275 and 18 respectively.

CAR REGISTRATIONS		
Jurisdiction	3rd Qtr 2009	4th Qtr 2009
Floyd County	84	39
Giles County	91	52
Montgomery County	580	305
Pulaski County	174	93
Radford City	78	37
Total	1,007	526

Source: Virginia Automobile Dealers Association.

TRUCK REGISTRATIONS		
Jurisdiction	3rd Qtr 2009	4th Qtr 2009
Floyd County	24	6
Giles County	20	20
Montgomery County	65	56
Pulaski County	28	25
Radford City	15	11
Total	152	118

Source: Virginia Automobile Dealers Association.

NRV Transportation News

The Bikeway-Walkway and Technical Advisory Committees met on the 16th of March to discuss a variety of regional projects and local planning initiatives. The Bikeway-Walkway Committee was joined by special guests from the Roanoke Valley Alleghany Regional Commission to discuss bicycle friendly communities. The presentation sparked interest amongst meeting participants to explore the official designation of bicycle friendly communities within their respective jurisdictions.

The Transportation Technical Advisory Committee reviewed the draft Rural Transportation Work Program. The FY 2011 work program is slated to receive level funding from FY 2010. The program proposes to provide assistance to VDOT on statewide plans, a corridor study in Montgomery County, and potentially partnering with the Blacksburg-Christiansburg-Montgomery Metropolitan Planning Organization (MPO) for a study on transit in the region. The work program as presented will continue to be a resource offering staff and technical assistance to a variety of communities in the region.

The Bikeway, Walkway, Blueway Plan is steadily progressing the last few months as individual meetings with jurisdictions in the region are completed. The draft document is scheduled to be prepared by mid May. This will be the first plan update in 10 years and will include existing facilities and future planning for each jurisdiction in the region.

The Rural Long-Range Plan will be preliminarily reviewed by the Planning District Commission and Virginia Department of Transportation prior to local jurisdiction reviews. The PDC will send content specific sections of the plan to TAC representatives for a thorough review. Once the preliminary review is complete, a draft of the document will be made available for public comment in June. For further information on transportation related issues, please contact Elijah Sharp at (540) 639-9313, ext. 210.



April 1, 2010 was National Census Day, have you mailed back your census form yet?

The Census Bureau has estimated that if every household completed and mailed back their census form, taxpayers could reduce the cost of taking the census by **\$1.5 billion**. The Census Bureau saves about \$85 million in operational costs for every percentage point increase in the nation's participation rate by mail.

As of March 31, 2010, the national census participation rate was 50% and Virginia was 55%. The New River Valley's participation rates were as follows: Montgomery County, 52%; Pulaski County, 59%; Giles County, 59%; Floyd County, 61%; and the City of Radford, 48%. Visit <http://2010.census.gov> and click on mail participation rate to find out how your locality is responding to the Census. Source: <http://2010.census.gov>

April 2010

SUN	MON	TUE	WED	THU	FRI	SAT
				1	2	3
4	5	6	7	8	9	10
11	12	13	14	15	16	17
18	19	20	21	22	23	24
25	26	27	28	29	30	

Meetings

- April 1-MPO Policy Board Meeting-MC Gov't Center-2 p.m.
- April 6-Blacksburg PC-7:30 p.m.
- April 7-Radford Transit Committee-1:30 p.m.
- April 12-Pulaski Town PC-6 p.m.; Pearisburg PC- 7 p.m.
- April 13-Pulaski PC-7 p.m.
- April 14-Montgomery PC-7 p.m.
- April 15-MPO TAC-MC Gov't Center-10 a.m.
- April 19-Radford PC-7 p.m.
- April 20-Floyd PC-7p.m.
- April 21-Montgomery PC-7 p.m.
- April 22-NRVPDC Commission Mtg.-6 p.m.
- April 27-Giles PC-6:30 p.m.; Hazard Mitigation Mtg.-NRVPDC-9 a.m.

May 2010

SUN	MON	TUE	WED	THU	FRI	SAT
						1
2	3	4	5	6	7	8
9	10	11	12	13	14	15
16	17	18	19	20	21	22
23/30	24/31	25	26	27	28	29

Meetings

- May 4-Blacksburg PC-7:30 p.m.
- May 6-MPO Policy Board Meeting-MC Gov't Center-2 p.m.
- May 10-Pulaski Town PC-6 p.m.; Pearisburg PC- 7 p.m.
- May 11-Pulaski PC-7 p.m.
- May 12-Montgomery PC-7 p.m.; NRV Commerce Park-Noon
- May 17-Radford PC-7 p.m.
- May 18-BWWW Mtg-NRVPDC-11:30 a.m.; TAC Mtg-NRVPDC-1:30 p.m.; Floyd PC-7p.m.;
- May 19-Montgomery PC-7 p.m.
- May 20-MPO TAC-MC Gov't Center-10 a.m.
- March 25-Giles PC-6:30 p.m.; Hazard Mitigation Mtg.-NRVPDC-9 a.m.
- May 27-NRVPDC Commission Mtg.-6 p.m.

THE COMPETITIVE EDGE

Official Publication of the New River Valley Competitiveness Center
A Small Business Incubator

Shawn Utt/Doug Hudson,
Acting Incubator Managers

April – May 2010

IRS Tax Support to Small Businesses

For those of you who are not aware, the IRS provides a Small Business/Self-Employed Virtual Small Business Tax Workshop. This extensive workshop is designed to help new and existing small business owners understand and meet their federal tax obligations. There are 9 lessons covered through the Business Tax Workshop:



1. Federal taxes and your new business
2. Setting up and running a new business
3. Paying your taxes using a computer (Sole proprietors, partnerships, Corporations, Charities/Non-profits)
4. Running your business out of your home
5. Retirement plans for owner & employees
6. Federal Taxes when hiring employees/contractors
7. How to manage payroll so you withhold the right amount from employees.
8. Making tax deposits and filing payroll taxes
9. Federal unemployment taxes (FUTA)

To learn more about the Small Business/Self-Employed Virtual Small Business Tax Workshop, visit <http://www.irs.gov>.

ANNOUNCEMENTS

Social Networking and Your Business – Understanding the Legal Aspects: Breakfast Briefing Sponsored by the Pulaski Chamber of Commerce and offered by Baker-Donelson Law Firm; Tuesday, April 27th at 8:00 am; MK's Pizzeria located at 4941 State Park Road, Dublin, VA 24084. For additional information, contact the Pulaski County Chamber of Commerce at 540-674-1991.

Small Business Fundamentals Series – The Radford Chamber of Commerce is sponsoring monthly workshops focused on the quirks of running a small business. On April 6th, the focus will be on **Risk Management** while the series spotlights **Small Business Start-up** on May 4th. Workshop sessions are held at the Chamber offices located at 200 Third Avenue, Radford, VA. For additional information, contact the offices at 540-639-2202 or visit their website at www.radfordchamber.com.

Pulaski County Small Business Expo 2010: *Standing the Test of Time* - The Pulaski County Small Business Expo will be held Thursday, May 20th at 1210 E. Main Street, Pulaski, VA (aka, the "old Lee Jeans building"). Exhibit space is still available. If interested in participating, contact the Chamber offices at 540-674-1991 or visit their website at www.pulaskichamber.info.



**FREE SUSTAINABILITY WORKSHOP FOR NRV
BUSINESSES**

go green NRV is happy to announce a free upcoming workshop available to all NRV businesses looking to 'go green' and learn how to participate in the *go green NRV* initiative.

The workshop will be held **Thursday, April 29th** at Mountain Lake Conservancy and Hotel in Pembroke, VA from 10:00 a.m. to 2:00 p.m. Workshop includes a complimentary lunch for all guests, informational session on calculating a business' carbon footprint, overview of the go green NRV program, and a tour of Mountain Lake to learn how the Hotel and Conservancy are using eco-friendly practices on the mountain.

Participating in the *go green NRV* initiative will help your business save money, improve employee wellness and productivity, increase marketing edge over competition, be a part of the new green economy, and most importantly, conserve resources and protect the environment.

To register for the workshop, please e-mail Emily Woodall at mlc@mountainlakehotel.com or call her at 540-626-7121 x444. Carpooling options available; please indicate your interest when registering. Space is limited, so register early! Registration deadline is **Monday, April 19th**.

go green NRV was established in the Fall 2008 to promote a Green Business Program for businesses in the New River Valley and is currently represented by companies in Floyd, Giles, Montgomery, and Pulaski counties, and the City of Radford. For more information on participating in the go green NRV initiative please visit: www.gogreenrv.com.

For Competitiveness Center information contact:

Shawn Utt or Doug Hudson, Acting Incubator Managers
6580 Valley Center Drive, Suite 302, Radford, VA 24141
Phone: (540) 633-6730 Fax: (540) 633-6768
incubatormanager@nrvdc.org or www.nrvdc.org/nrvcc.html



New River Valley Planning District Commission
 6580 Valley Center Drive, Suite 124
 Radford, VA 24141

PRSR STD
 U.S. POSTAGE
 PAID
 RADFORD, VA
 PERMIT NO. 35

RIDE Solutions: May is Bike Month!

•••••
 Jan R. Gilbertson, Newsletter Editor
 jgilbertson@nrvdc.org

RIDE Solutions is partnering with other local organizations to celebrate Bike Month. There are several events already planned including a chance for you to get a free, basic tune-up for your bike in April. More information and events will be posted on-line at www.ridesolutions.org/cleancommute/index.shtml, but here's what's planned for now:

Fix Fest and Bike Swap
 April 17, 9am to noon —Draper Avenue adjacent to the Blacksburg Farmer's Market

Fix Fest: Dust off your bike, pump up the tires, and grease the chain. Spring is here! You can bring your bike downtown for a free check and basic tune up. Local bike shops —Bike Barn, East Coasters, and Hokie Spokes—will be on hand with mechanics

offering basic services. (Participants that require part replacement or more involved repairs will be referred to the bike shops.)

Bike Swap: Come out and barter, trade, buy or sell bike-related goods. Anyone with a surplus of road, mountain or commuter bike stuff (e.g., frames components, clothing or complete bikes) can reserve a sellers' space at the Bike Swap. Contact for the bike swap is Ed Hokanson at (540)552-7825 or by email at edh@email.com. Presented by Sustainable Blacksburg and sponsors: NRV Bicycling Association, Town of Blacksburg, RIDE Solutions, Hokie Spokes, Bike Barn, East Coasters

Clean Commute Fridays
 Every Friday in May

Clean Commute participants will pledge to use a cleaner commute mode – biking, walking, riding the bus, carpooling – on one or more Fridays in May. Each day pledged is an entry for the prize drawing which will include a variety of prizes. You can make your pledge and sign up on-line at the website listed above. Bike to Work routes (NRV routes are being added this month) are also available to help get you ready for Clean Commute Fridays. You can also enter the Cleanest Team competition.

Blacksburg's designated Clean Commute day is May 21. Hospitality stations will be set up at Blacksburg's Farmer's Market and the Corporate Research Center during the morning commute (7:30 to 9 am). For further information, contact Christy Straight at cstraight@nrvdc.org or (540) 639-9313, ext. 209.

*We're on
 the web at
nrvdc.org*

**If you would like
 to receive this
 newsletter
 electronically,
 please email
nrvdc@nrvdc.org.**

New River Valley News & Views



NEW RIVER VALLEY PLANNING DISTRICT COMMISSION

6580 Valley Center Drive, Suite 124, Radford, VA 24141
 Ph: 540.639.9313 | Fax: 540.831.6093 | nrvpdc@nrvc.org | www.nrvpdc.org

Inside this issue:

NRVPDC UPDATES	2
NRVPDC COMMISSION MEETING SUMMARIES	3
NRV ECONOMIC INDICATORS	4
U.S. CENSUS 2010	4
NRV TRANSPORTATION NEWS	4
CALENDARS	5
THE COMPETITIVE EDGE	Insert
RIDE SOLUTIONS	6

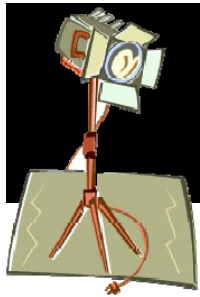

“eCorridors program to begin consumer broadband mapping campaign in NRV” in the Spotlight

The National Broadband Plan states that no matter where you live or how much money you make every American, every school, every library, every business, every health care and public safety facility needs to have access to affordable broadband services. Broadband has become the foundation of the American economy and the platform required for innovation and opportunity. It is the tool every child needs if they are to learn and compete in the global economy. Access to affordable broadband infrastructure is required to ensure that businesses, large and small, are created here, move here and stay in the New River Valley (NRV).

Not everyone in the NRV has access to high speed Internet, and not everyone who has access to broadband subscribes. In an effort to understand and improve this situation, Virginia Tech's eCorridors program (<http://www.ecorridors.vt.edu>) will

introduce a new broadband mapping portal this summer, as well as a new consumer education and participation campaign in the region.

In the past, providers have been the primary source of information regarding where internet services, broadband or otherwise, are available. For the first time, Virginia residents, businesses, educational institutions, healthcare facilities, public safety groups and others are being asked to provide information about Internet service availability in their communities. To compete globally, create opportunities, and maximize investment in broadband infrastructure, Virginia needs a more precise understanding of where and what kind of internet services are available.

As a partner in the Virginia broadband mapping initiative, eCorridors is requesting assistance in the collection of at least 300 or more new speed test (<http://www.ecorridors.vt.edu/>

maps/broadbandmap.php) data points per county to achieve a statistically significant sample size. This is necessary to adequately model current broadband availability in the state.

Combined with other data sources, the eCorridors speed test data will be used for updating Virginia's state broadband map of served, under-served, and unserved areas, as well as to validate providers claimed coverage. This data will be used to identify areas in need of affordable broadband infrastructure investment.

Be a part of history. Urge your community to participate in a local speed testing campaign. For more information and to organize a local speed test campaign in your area, contact Jean Plymale at (540) 231-2270 or vplymale@vt.edu.

NRVPDC Commissioners

- **FLOYD COUNTY**
EVELYN JANNEY
FRED GERALD
- **GILES COUNTY**
RICHARD MCCOY
VACANT
- **MONTGOMERY COUNTY**
ANNETTE PERKINS
JAMES POLITIS
MIKE HARVEY
- **PULASKI COUNTY**
JOSEPH SHEFFEY
SHAWN UTT
- **CITY OF RADFORD**
HELEN HARVEY
THOMAS STARNES, CHAIR
- **TOWN OF BLACKSBURG**
DON LANGREHR
HOLLY LESKO
- **TOWN OF CHRISTIANSBURG**
HENRY SHOWALTER
SCOTT WEAVER, TREASURER
- **TOWN OF FLOYD**
MIKE PATTON
- **TOWN OF NARROWS**
TOM GARRETT
- **TOWN OF PEARISBURG**
REBECCA MOSES, VICE CHAIR
- **TOWN OF PULASKI**
JEFF BAIN
LARRY CLEVINGER
- **TOWN OF RICH CREEK**
DARLENE FRENCH
- **RADFORD UNIVERSITY**
VACANT
- **VIRGINIA TECH**
DAVID DENT
KEVIN SULLIVAN

KEVIN R. BYRD, AICP
 EXECUTIVE DIRECTOR
kbyrd@nrvc.org



NRVPDC Updates

Town of Pearisburg Local Planning Assistance

The Town of Pearisburg Zoning Ordinance update and Zoning Map has been adopted. A joint public hearing was held on April 13th, 2010. The update to this ordinance and the Town of Pearisburg Subdivision Ordinance in 2008 include changes required by law and is in keeping with the Town Comprehensive Plan. Updates to the Zoning Ordinance specifically address issues related to land use and will provide additional opportunities to citizens, business owners, and property owners while keeping with the needs of the Town. Changes to the Zoning Map include zoning changes that occurred after the previous adoption of the Zoning Map. *For further information, please contact Jack Whitmore at (540) 639-9313, ext. 259.*

Floyd County Comprehensive Plan Update

Floyd County is currently in the process of a Comprehensive Plan update. This update is being completed to reflect changes that have occurred in the County since the last adopted Comprehensive Plan (2002). Focus groups have been held concerning agriculture, tourism planning, infrastructure, economic development, recreation, wellness, solid waste management, public safety, and housing and human service issues in the County.

Community input meetings will be conducted in late June and throughout July in Indian Valley, Willis, Check, and the Town of Floyd. Information gathered at these meetings will allow for additional information to be included in the draft with additional detail directed to future land uses. *For further information, please contact Jack Whitmore at (540) 639-9313, ext. 259.*

Town of Floyd Comprehensive Plan

The Town of Floyd has begun the process of creating a Comprehensive Plan for the Town with data and primary focus group information being analyzed and plan elements being drafted. Draft mapping of future land uses is currently being examined with additional detail on future services. Information related to the Town Comprehensive Plan is also being augmented with County data to provide cohesive information related to infrastructure, community services, and economic development. This plan has been

envisioned to be a stand alone plan while simultaneously being incorporated into the Floyd County Comprehensive Plan. *For further information, please contact Jack Whitmore at (540) 639-9313, ext. 259.*

NRV HOME Consortium

HOME Staff have been working closely with Giles County in order to identify, prioritize, and select a HOME-assisted project. The County has expressed a need for senior housing – residents have been without County-based assisted living options for nearly a decade, leaving seniors the choice of aging in place or finding assisted living care outside of the County. With the assistance of HOME staff, Giles will receive project submissions and select a housing project to begin in FY 2011. *For further information, please contact Jennifer Wilsie at (540) 639-9313, ext. 204.*

Mobility Management

Drafting of the Transit Resource Manual has begun. This manual, once complete, will provide a comprehensive overview of all the region's transit options. Initially, this hardcopy manual will be used internally by a procured Mobility Manager to liaison with citizens seeking transit information. In the future, the manual will be translated to an online interactive website, allowing the public to access this information as well. This project is being funded through a Mobility Management Grant under the Department of Rail and Public Transportation. *For further information, please contact Jennifer Wilsie at (540) 639-9313, ext. 204.*

Disability Services Board

At the last Disability Services Board meeting, the group assisted the PDC in updating the New River Valley's Hazard Mitigation Plan. The meeting focused on populations affected by physical, sensory, and/or cognitive disabilities, highlighting preventative measures to protect these vulnerable populations in times of natural disaster.

The group also discussed ways in which to expand its impact into the New River Valley, including educational opportunities, utilizing networking opportunities, and conducting an ongoing needs assessment for those with disabilities in the NRV. *For further information, please contact Jennifer Wilsie at (540) 639-9313, ext. 204.*

Pulaski County Community Development Block Grant: Baskerville Neighborhood Rehab Project

The PDC has submitted a Community Development Block Grant on behalf of Pulaski County. The Baskerville Neighborhood Rehabilitation Project area is located southwest of the Town of Dublin in Pulaski County, Virginia and proposes to provide housing rehabilitation to 11 homeowners and one renter, substantial reconstruction to six homeowners, and water and sewer line upgrades to the project area.

The County has requested \$1,000,000 from DHCD for this project and will leverage \$48,700 in local funds, \$207,345 in HOME funds, \$25,000 from Southeast Rural Community Assistance Program (SERCAP), \$180,000 in State HOME funds, and \$43,050 in State Weatherization funds available through Community Housing Partners, for a \$1,504,095 total project budget. Grant award notices should be announced by early summer. *For further information, please contact Jennifer Wilsie at (540) 639-9313, ext. 204.*

Green Infrastructure

Work continues on developing a resource for local government planning departments, as well as partner agencies describing the natural and cultural assets in the region. This resource is planned to be available by the end of June. To accompany a print resource outlining these resources, a new and improved website is currently under construction. This website will provide updated information and resources for the public and local officials. The website will be made public by the end of June. *For further information, please contact Regina Elsner at (540) 639-9313, ext. 205.*



New River Valley Hazard Mitigation Plan

The Geologic Hazards Working Group met in March, while the Severe Weather Hazards Working group met in May. The Geologic Hazards Working Group was scheduled to meet in April to discuss rockfall and Karst, but was postponed due to delays in finalizing the data. The

second Geologic Hazards Working Group meeting will be rescheduled for sometime in early June, and the Flooding Working Group will meet on June 29. The final working group meeting will be held on July 27 to discuss wildfire and human-caused hazards.

As sections of the plan are completed, they are posted at www.nrvpdc.org/HazardMitigation/HazardMitigationPlanning.html. Please continue to check back as the website will be updated regularly. For further information on Hazard Mitigation, please contact Christy Straight at cstraight@nrpdc.org or Regina Elsner at relsner@nrpdc.org or by phone at (540) 639-9313.

New River/Mount Rogers

Workforce Investment Board (WIB)

The New River/Mount Rogers Workforce Investment Board (WIB) recently received notification that an additional \$100,000 of Stimulus Youth funds would be available effective May 1, 2010, to serve Youth during Summer 2010 providing work readiness instruction and work experience for approximately six (6) weeks.

Additionally, the WIB will be receiving an additional \$2.4 million in formula WIA funds for PY'10 program activities. It is anticipated that approximately \$3.5 million will be available for PY'10 from all funding sources. These funds are badly needed with the unemployment rates among the jurisdictions in the New River Valley and Mount Rogers areas remaining high. Funds will be used for case management, assessment, training and supportive services in order for WIA clients to receive training and placement in an occupation that is in demand or a growth occupation paying a wage that will lead to economic self sufficiency. The WIB expects to serve a minimum of 1,000 eligible citizens using the funds that will be available and anticipates that 80% of those served will be placed in unsubsidized employment.

For further information, please contact Ronnie Martin at (540) 633-6764 or email rmartin@nrpdc.org.

NRVPDC Commission meetings are held on the fourth Thursday of every month, 6:00 p.m. at the New River Valley Competitiveness Center in Fairlawn. All meetings are open to the public.

NRVPDC Commission Meeting Summaries

April 22, 2010

VA Geologic Mapping Advisory Committee:

- Public/private sector representation
 - Review geologic mapping proposals for VA
 - Localities need GIS files, not just pdf files
- How geology relates to economy is important message
- Receive updates on Division of Geology and Mineral Resources projects
 - Comprehensive Planning Resources (maps, mineral productions)

NRV Development Corporation:

- Considering refinancing with NBB
- NRVPDC application to RD for Rural Business Enterprise Grant
 - 50% support for small business support/marketing at Competitiveness Center
 - 50% geared toward business development for value-added growers/producers, "green" business development (bio-mass, energy companies)

Workforce Investment Board:

- Establishing independent agency - major undertaking to separate two agencies
 - Previously PDC employees
 - PDC performed all payroll, human resource, and fiscal agent duties for WIB
- WIB solicited proposals from local governments/PDCs in the service area to serve as fiscal agent. Proposals due April 26th. NRVPDC submitting proposal

VDOT Six Year Improvement Program (SYIP) Public Hearing:

- June 3rd at New River Community College - 5:00 pm Local Government Officials Meeting, 6:00 pm General Public - Draft SYIP not yet released

NRV Tourism Website:

- RFP for website designer released on 3/23
- Bids were due April 19th - 9 bids received (4 local firms, 5 out of state firms) with a short list comprised of 2 local firms; Firm to be selected by May 7th

May 27, 2010

Economic Development Grant:

- Submitting 3-year Economic Development District (EDD=PDC) Planning Grant
- Same funding level as previous years, \$70,000 with 50% match
- Work Program:
 - CEDS Implementation and Annual Updates; Project Development Assistance; Technical Assistance (Databook, Newsletter, Website); Administration of Funds

Vision 2020/CEDS:

- Drafting "Consumer" version of Vision 2020; 80+ page CEDS report sent to EDA
- Consumer version focuses on:
 - Process and 4 key projects by strategy area (People/Education, Business/Industry and Employment, Natural and Cultural Resources, Physical Infrastructure)
 - Projects are presented with the Goal/Objective, the project description, funding amounts/sources, responsible agency
 - Appendix with projects by locality
 - Intention is to clearly convey projects and strategies
- Summer Intern: Evan Klein, VT student, drafting consumer version

Southwest Virginia Downtowns:

- Meeting held May 26
- Focus on why downtowns succeed
- Why was downtown started? Still relevant?
- Galax economic development shift
- Heartwood Community Videos (Total project cost \$7,000 (ARC share \$3,500/Local share \$3,500))

NRV Tourism Website:

- Firm selected May 7th was Citizens Co-op from Floyd

NRV Development Corporation:

- Refinanced loans this week; decreased Trane contract by 23%; sold Road tractor for \$7,200
- Potential Christiansburg contribution



NRV Economic Indicators

Labor Force and Unemployment

Almost all NRV jurisdictions experienced decreases in their labor force between the 3rd and 4th quarters of 2009. Also, almost all NRV jurisdictions experienced decreases in their unemployment rate in the same time period, except Giles County which remained the same.

AGGREGATE LABOR FORCE

Jurisdiction	3rd Qtr 2009	4th Qtr 2009
Floyd County	22,195	22,012
Giles County	25,337	25,659
Montgomery County	137,756	138,975
Pulaski County	55,880	55,468
Radford City	24,405	24,293
New River Valley	265,573	266,407

Source: Virginia Employment Commission.

AVERAGE UNEMPLOYMENT RATE

Jurisdiction	3rd Qtr 2009	4th Qtr 2009
Floyd County	7.4%	7.3%
Giles County	8.9%	8.9%
Montgomery County	6.9%	6.6%
Pulaski County	11.4%	9.6%
Radford City	9.6%	8.0%
New River Valley	8.4%	7.6%

Source: Virginia Employment Commission.

Employment and Wages

The NRV's 3rd quarter wage data for 2008 and 2009 shows a decrease in average employment of 3,431 (5%) persons. The weekly wage increased (\$6) and the number of establishments increased (9 or .2%).

AVERAGE EMPLOYMENT

Jurisdiction	2008 3rd Qtr	2009 3rd Qtr
Floyd County	2,833	2,783
Giles County	4,864	4,759
Montgomery County	40,077	39,436
Pulaski County	13,954	11,753
Radford City	6,219	5,785
NRVPDC	67,947	64,516

Source: Virginia Employment Commission.

AVERAGE WEEKLY WAGE

Jurisdiction	2008 3rd Qtr	2009 3rd Qtr
Floyd County	\$485	\$495
Giles County	627	633
Montgomery County	725	728
Pulaski County	590	594
Radford City	708	718
NRVPDC	679	685

Source: Virginia Employment Commission.

AVERAGE ESTABLISHMENTS

Jurisdiction	2008 3rd Qtr	2009 3rd Qtr
Floyd County	375	384
Giles County	366	369
Montgomery County	2,185	2,197
Pulaski County	734	727
Radford City	354	346
NRVPDC	4,014	4,023

Source: Virginia Employment Commission.



If you didn't send back your Census form, do you have to talk to a Census taker? Yes. Your participation in the 2010 Census is vital and required by law, ([Section 221, of Title 13 of the U.S. Code](#)). There is no need to worry about privacy and confidentiality. The census taker who collects your information is sworn for life to protect your data under [Federal Law Title 13](#). Those who violate the oath face criminal penalties: Under federal law, the penalty for unlawful disclosure is a fine of up to \$250,000 or imprisonment for up to 5 years, or both. Source: <http://2010.census.gov/2010census/how/census-taker.php>

NRV Transportation News

- ▶ The New River Valley finds success in the FY '11 Transportation Enhancement and Safe Routes to Schools grant programs. This year Enhancement funds are tentatively scheduled to be awarded to the Towns of Floyd, Pearisburg, Rich Creek, and Christiansburg and the Counties of Giles and Montgomery for a variety of bicycle and pedestrian improvements. The Town of Blacksburg was successful in receiving funds for the Harding Elementary School sidewalk and pedestrian refuge infrastructure project. The Planning District Commission would like to thank the Commonwealth Transportation Board representatives and program staff at VDOT for their support on these projects. Congratulations to all the recipients!
- ▶ The Planning District Commission will be working with the City of Radford to provide assistance in implementing fixed route mass public transportation services. This exciting project will provide alternative transportation for City residents and students of the University in the years to come.
- ▶ The Bikeway-Walkway Committee met on May 18th to discuss a variety of regional projects and local planning initiatives. The Committee hosted a special presentation from the Blacksburg Corridor Committee regarding their local bicycle improvements survey. This project is providing the foundation for developing designated bicycle routes and pedestrian safety improvements in the Town through a unique partnership with Virginia Tech's CGIT department. New developments and findings associated with this project are forthcoming.
- ▶ The Rural Long Range Plan draft recommendations have been sent to the Planning District Commission for initial review. The Transportation Technical Advisory Committee meeting was rescheduled to Tuesday June 29th at 1:30 pm in Fairlawn to provide feedback on the document. This Statewide plan is on track to be finished in late Fall and will involve a public comment period as it nears completion.
- ▶ The draft Six Year Improvement Plan was posted on the VDOT website on May 19th for public review. A public meeting was held June 3rd at New River Community College to provide citizens, elected officials and local governments an opportunity to voice their respective views and ideas. The New River Valley is fortunate to have critical bridge structures on the current funding allocation schedule for Routes 114, 61, and 219. The PDC will be looking at creative ways to develop sustainable transportation planning for the communities of the NRV as we move into the future with limited funding opportunities. For further information on transportation related issues, please contact Elijah Sharp at (540) 639-9313, ext. 210.

June 2010

SUN	MON	TUE	WED	THU	FRI	SAT
		1	2	3	4	5
6	7	8	9	10	11	12
13	14	15	16	17	18	19
20	21	22	23	24	25	26
27	28	29	30			

Meetings

- June 1-Blacksburg PC-7:30 p.m.
- June 3-VDOT SYIP FY2011-2016-6 p.m.-NRCC; MPO Policy Board Meeting-MC Gov't Center-2 p.m.
- June 8-Pulaski PC-7 p.m.
- June 9-Montgomery PC-7 p.m.
- June 14-Pulaski Town PC-6 p.m.
- June 16-Montgomery PC-7 p.m.
- June 17-MPO TAC-MC Gov't Center-10 a.m.
- June 21-Radford PC-7 p.m.; Pearisburg PC-7 p.m.
- June 22-Floyd PC-7p.m.
- June 24-NRVPDC Commission Mtg.-6 p.m.
- June 29-TAC Mtg.-NRVPDC-1:30 p.m.; Hazard Mitigation Mtg.-NRVPDC-9 a.m.; Giles PC-6:30 p.m.

July 2010

SUN	MON	TUE	WED	THU	FRI	SAT
				1	2	3
4	5	6	7	8	9	10
11	12	13	14	15	16	17
18	19	20	21	22	23	24
25	26	27	28	29	30	31

Meetings

- July 1-MPO Policy Board Meeting-MC Gov't Center-2 p.m.
- July 6-Blacksburg PC-7:30 p.m.
- July 12-Pulaski Town PC-6 p.m.
- July 13-Pulaski PC-7 p.m.; VA's First-4:30 p.m.
- July 14-Montgomery PC-7 p.m.; MPO TAC-MC Gov't Center-10 a.m.
- July 19-Radford PC-7 p.m.; Pearisburg PC-7 p.m.
- July 20-BWWW Mtg-NRVPDC-11:30 a.m.; TAC Mtg-NRVPDC-1:30 p.m.; Floyd PC-7p.m.
- July 21-Montgomery PC-7 p.m.
- July 22-NRVPDC Commission Mtg.-6 p.m.
- July 27-Hazard Mitigation Mtg.-NRVPDC-9 a.m.; Giles PC-6:30 p.m.

THE COMPETITIVE EDGE

Official Publication of the New River Valley Competitiveness Center
A Small Business Incubator

Shawn Utt/Doug Hudson,
Acting Incubator Managers

June – July 2010

Renting Office Space – the Why's and Why Not's

At some point, all growing small businesses are faced with the question of leasing versus buying office space. This question has many pros and cons. In order to make their decision easier, key facts to consider when leasing office space are discussed in the About.com Guide.

With ever-changing U.S. office vacancy rates and stock markets, it is uncertain what the future may bring. A small business owner needs to carefully weigh their options when leasing office space. Here are a few reasons to consider leasing office space.

- ◎ **Prime Property:** A leasing office space option provides a business with the chance to rent in an area with a good location and high image. If your small business is dependent on location and image, such as service providers or retail establishments, the leasing option is much more affordable.
- ◎ **Free-up Working Capital:** With your money not tied up in real estate your business can respond to opportunities in the market. In addition, your ability to borrow funds will not be as limited as with buying office space.
- ◎ **More Time:** Any type of ownership comes with headaches. A leasing option affords the time and flexibility to focus solely on running your business.

SMALL BUSINESS FUNDING OPTIONS

Funding opportunities are often determined by small business growth status. Below are a few of the most popular funding sources, including small business loans, Small Business Administration loans, bank loans, venture capital investors and angel investors. Determining the best source for your company isn't always easy. You need to graph your whole business plan and presentation to the source that is most likely to fund your project. So choose wisely, and be ready to change direction at any time.

A quick summary of small business growth funding alternatives you may be looking at are listed for your review. However, there are no hard and fast rules. The best funding option for your company is often the one you can obtain. Check out the following website for additional details in business plans - <http://www.businessplanmaster.com/small-business-growth.html>

	Bootstrap	Angels	VC	SBA	Leasing	Grants	Alternative
Pre-Start Up	YES	YES				YES	
Start Up	YES	YES	YES	IFFY	YES		YES
Established			YES	YES	YES	YES	YES
Buy Out				YES	YES		YES

ANNOUNCEMENTS and UPCOMING EVENTS

The W.O.W. Factor Customer Service Training – The New River Community College’s Office of Workforce Development, in partnership with the Virginia Tourism Corporation, will be sponsoring



this great Customer Service Training geared to all levels of employees. Come and learn what it means to just “give ‘em the pickle”. The workshop will be held on Wednesday, June 23rd from 10:00 am to noon and is free to all participants. Register online at www.nr.edu or contact the Office of Workforce Development at 540.674.3613.

Entrepreneur Express Workshop – The Entrepreneur Express is a business development workshop presented by the Virginia Department of Business Assistance and is being sponsored by the Pulaski County Chamber of Commerce, the NRV Competitiveness Center, Virginia Economic Bridge and Wachovia. The series will provide participants with interactive discussions and presentations covering key elements of business practices, including: How to Start & Operate a Business, Growing your Business/Marketing Strategy, Financing/Managing Resources and Available Resources & Resource Fair. The workshop will be held at the NRV Competitiveness Center on Thursday, August 19th beginning at 9:00 am through noon. For additional information or to register, call the Pulaski County Chamber of Commerce offices at 540.674.1991 or go to www.vastartup.org/register/events/204



Montgomery County Chamber of Commerce 2010 Member Expo is coming on August 19th in conjunction with the August Business After Hours. It will be held at the Holiday Inn University, 900 Prices Fork Road, Blacksburg and will be open to the public from 3:00 to 5:30 pm. If you are interested in participating, call the Chamber office at 540.552.2636 or email the Chamber staff at dlyons@montgomerycc.org

Pulaski County Chamber of Commerce - Is your business looking for just the right employee to fill that job opening? Post your job openings free of charge on the Chamber web site. This is one of the latest additions to the services the Chamber is offering to members. To add your listings, contact the chamber office at pchamber1@swva.net or call 540.674.1991.

For Competitiveness Center information contact:

Shawn Utt or Doug Hudson, Acting Incubator Managers
6580 Valley Center Drive, Suite 302, Radford, VA 24141
Phone: 540.633.6730 Fax: 540.633.6768
incubatormanager@nrfdc.org or www.nrfdc.org/nrvcc.html



New River Valley Planning District Commission
 6580 Valley Center Drive, Suite 124
 Radford, VA 24141

RIDE Solutions: A Successful Bike Month in 2010!

RIDE Solutions partnered with Sustainable Blacksburg, the New River Valley Bicycling Association, and the Town of Blacksburg to celebrate Bike Month with two new events in Blacksburg: the *Fix Fest and Bike Swap* and a *Clean Commute Fridays* celebration.

They had a great turnout for the inaugural Fix Fest and Bike Swap at the Blacksburg Farmers' Market. Over 70 bikes were tuned up and made road-ready on April 17. Vendors for the bike swap brought several dozen bikes out from storage that went home with new owners.

This was the first year for the event and it was exciting to see such a good turnout – especially when we weren't sure what to expect. Being set up next to the new and improved Farmers'

Market certainly helped – bystanders saw what they were up to and went home to get their bikes!

Quite a few groups and volunteers contributed their time to putting on this event, including the sponsors they partnered with and local bike shops who sent mechanics for the tune-up work. Without Bike Barn, East Coasters, and Hokie Spokes, Sustainable Blacksburg, the New River Valley Bicycle Association, the Town of Blacksburg, and Modea giving their time and effort, this wouldn't have been possible.

On the third of four Clean Commute Fridays in May (May 21), RIDE Solutions hosted hospitality stations at the Blacksburg Farmer's Market and the Corporate Research Center

during the morning commute to thank those who take the clean commute pledge. Blacksburg Transit provided buses at both sites to demonstrate how to use the bike racks on the front of BT buses.

Every year, RIDE Solutions runs a Clean Commute campaign to encourage commuters to use a cleaner commute mode – biking, walking, riding the bus, carpooling – on one or more Fridays in May. Participants pledge to use a cleaner commute mode, register their miles online, and are entered for a prize drawing. This year, 200 participants pledged nearly 10,000 miles!

If you're interested in setting up a Bike Month or Clean Commute event in your community next year, we can help – it's not too early to start planning! Contact Christy Straight at cstraight@nrvdc.org or (540) 639-9313, ext. 209, for more information.

•••••
 Jan R. Gilbertson, Newsletter Editor
jgilbertson@nrvdc.org

*We're on
 the web at
nrvdc.org*

**If you would like
 to receive this
 newsletter
 electronically,
 please email
nrvdc@nrvdc.org.**

New River Valley News & Views



NEW RIVER VALLEY PLANNING DISTRICT COMMISSION

6580 Valley Center Drive, Suite 124, Radford, VA 24141
 Ph: 540.639.9313 | Fax: 540.831.6093 | nrvpdc@nrvpdc.org | www.nrvpdc.org

Inside this issue:

NRVPDC UPDATES	2
NRVPDC COMMISSION MEETING SUMMARY	3
NRV ECONOMIC INDICATORS	4
U.S. CENSUS 2010	4
NRV TRANSPORTATION NEWS	4
CALENDARS	5
THE COMPETITIVE EDGE	Insert
GREEN INFRASTRUCTURE WEBSITE UPDATE	6

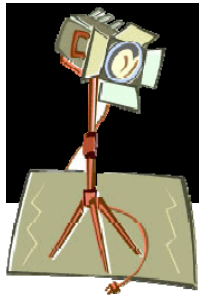

“Hazard Mitigation” in the Spotlight

Do you know when and where the last major earthquake occurred in the New River Valley? How strong was it on the Richter scale? (Answers at the end.)

Did you know that flooding affects almost every locality in the New River Valley? Even just one foot of water is enough to float many vehicles – something to keep in mind when the streams rise over the roadways.

Flooding and earthquakes are just two of the most dramatic natural hazards being studied as the NRVPC updates the region's All Hazards Mitigation Plan. Other hazards included in the plan are drought, severe weather, landslides, and wildfires.

A Hazard Mitigation Plan is required by the Federal Emergency Management Agency (FEMA) for localities that wish to apply for federal funds to mitigate the impacts of natural hazards on their communities. Mitigation is defined as sustained actions taken to reduce or

eliminate long-term risk from hazards and their effects. For example, some communities have used mitigation funds to acquire flood-prone properties and turn them into community green spaces and parks.

The Hazard Mitigation Plan is developed to identify the hazards specific to our communities and analyze the risks associated with those hazards. Once the hazards have been identified and the risks assessed, communities develop strategies to mitigate the risks and identify specific projects to pursue.

Projects identified in this plan are eligible for funding from FEMA and other sources. Some common projects funded from these efforts include measures to mitigate the repeated effects of flooding on residences and businesses.

The original NRV All Hazards Mitigation Plan was developed in 2004 and approved by FEMA in 2005. Since this approval, several regional projects have been completed, including the official organizing of a regional swiftwater rescue team.

FEMA requires an update of the plan every 5 years, so in 2009 the NRVPC received funding to collaborate with Radford University to complete this update. For the past year, a steering committee has been meeting to discuss the plan and regional hazards. Since the beginning of 2010, working groups have been meeting for in-depth discussions of individual hazards and to brainstorm mitigation strategies specific to each hazard.

As part of the update, new mapping has been created by Radford University. This mapping is unique to the NRV and sets it apart from other regions in the state with its higher level of analysis and the new information for our communities.

Now that the working groups have completed their work, it is time for public review and input. In the coming months, the NRVPC will be hosting meetings for the public to review the information and provide input and comments on *(continued on page 2)*

NRVPDC Commissioners

- **FLOYD COUNTY**
EVELYN JANNEY
FRED GERALD
- **GILES COUNTY**
RICHARD MCCOY
VACANT
- **MONTGOMERY COUNTY**
ANNETTE PERKINS
JAMES POLITIS
MIKE HARVEY
- **PULASKI COUNTY**
JOSEPH SHEFFEY
DOUG WARREN
- **CITY OF RADFORD**
HELEN HARVEY
TIM COX
- **TOWN OF BLACKSBURG**
DON LANGREHR
HOLLY LESKO, VICE CHAIR
- **TOWN OF CHRISTIANSBURG**
HENRY SHOWALTER
SCOTT WEAVER, TREASURER
- **TOWN OF FLOYD**
MIKE PATTON
- **TOWN OF NARROWS**
TOM GARRETT
- **TOWN OF PEARISBURG**
VACANT
- **TOWN OF PULASKI**
LARRY CLEVINGER
MORGAN WELKER
- **TOWN OF RICH CREEK**
VACANT
- **RADFORD UNIVERSITY**
VACANT
- **VIRGINIA TECH**
DAVID DENT
KEVIN SULLIVAN

KEVIN R. BYRD, AICP
 EXECUTIVE DIRECTOR
 kbyrd@nrvpdc.org

Condolences...

The recently elected Chair of the New River Valley Planning District Commission, **Rebecca Moses**, passed away on July 23, 2010. Mrs. Moses represented the Town of Pearisburg on the Commission and was an active member of her community. She served 21 years on the Pearisburg Town Council, Vice-Mayor of Pearisburg for eight years, and served on the Pearisburg Planning Commission. Mrs. Moses was a valuable and dedicated member of the NRVPC for over 7 years, serving the last two years as Vice Chair. She will be deeply missed and our condolences go out to her family, friends, and her community.

the plan. In the meantime, section drafts will be posted on the website hosted by the NRVPCD (available at: <http://www.nrvpcd.org/HazardMitigation/HazardMitigationPlanning.html>). Comments on the plan can also be submitted at this site which will be sent to PDC planners to incorporate as they draft the plan.

Following public input and review by the localities, a draft plan will be sent to the Virginia Department of Emergency Management and then to FEMA for review and approval. Once approved by those agencies, local governments will adopt the final plan, making them eligible to apply for federal mitigation funds. The NRVPCD anticipates having the plan written and in the review process by the end of the year.

(Answer: In 1897 a 5.8 magnitude earthquake struck southeast of Pearisburg.)

For further information on Hazard Mitigation, please contact Christy Straight at cstraight@nrvpcd.org or Regina Elsner at relsner@nrvpcd.org or by phone at (540) 639-9313.

NRVPCD Updates

Floyd County Comprehensive Plan Update

Floyd County is currently in the process of a Comprehensive Plan update. This update is being completed to reflect changes that have occurred in the County since the last adopted Comprehensive Plan (2002). Focus groups have been held concerning agriculture, tourism planning, infrastructure, economic development, recreation, wellness, solid waste management, public safety, and housing and human service issues in the County.

Two of four community input meetings were held on July 15, 2010 at the Indian Valley Elementary School and on August 3, 2010 at Willis Elementary School. Additional meetings are scheduled for August 12, 2010 at the Jessie Peterman branch library in Floyd and August 19, 2010 at Check Elementary School. All input meetings will be held from 7:00 p.m. to 9:00 p.m. Information gathered at these meetings will allow for additional information to be included in the draft. For further information, please contact Jack Whitmore at (540) 639-9313, ext. 259.

Town of Floyd Comprehensive Plan

The Town of Floyd has begun the process of creating a Comprehensive Plan for the Town. With data and primary focus group information being analyzed, plan elements are being drafted. Information related to the Town Comprehensive Plan is also being augmented with County data to provide

cohesive information related to infrastructure, community services, and economic development. This plan has been envisioned to be a stand alone plan while simultaneously incorporating into the Floyd County Comprehensive Plan. Additionally, Town residents and business owners are encouraged to come to any of the community input meetings to discuss issues related to the Town and County. For further information, please contact Jack Whitmore at (540) 639-9313, ext. 259.

Mobility Management

The PDC has just completed a draft of the Mobility Resource Manual, a document that compiled information on each major transportation provider in the New River Valley to be used by a Mobility Manager in the project's implementation phase. The manual will allow the Mobility Manager to have first-hand knowledge of the transportation options in the New River Valley and direct clients to the most appropriate provider.

The PDC will be working closely with its stakeholders to review and revise the draft before a final document is published. For further information, please contact Jennifer Wilsie at (540) 639-9313, ext. 204.

Pulaski Adult Day Care and Fall Prevention Center

Pulaski County is applying for a Community Development Block Grant (CDBG) Planning Grant for a proposed adult day care facility in the County. Currently, the project is assembling a management team and surveying beneficiaries who may be interested in this service. If funded, the County could request up to \$700,000 for this project. For further information, please contact Jennifer Wilsie at (540) 639-9313, ext. 204.

Pulaski County Community Development Block Grant: Baskerville Neighborhood Rehab Project

The Baskerville Neighborhood Rehabilitation grant submitted on behalf of Pulaski County has been funded for its full \$1,000,000 request by the Department of Housing and Community Development (DHCD). In addition, the project has leveraged \$48,700 in local funds, \$207,345 in HOME funds, \$25,000 from Southeast Rural Community Assistance Program (SERCAP), and \$43,050 in State Weatherization funds available through Community Housing Partners. The funds will be used to rehabilitate or substantially reconstruct 18 single-family households in the Baskerville neighborhood, as well as to fund infrastructure improvements in the neighborhood.

The County has already begun work on the preliminary activities required before getting under contract with DHCD. For further information, please contact Jennifer Wilsie at (540)

639-9313, ext. 204.

New River/Mount Rogers Workforce Investment Board (WIB)

The New River/Mount Rogers Workforce Investment Board, through its partnership with surrounding Workforce Investment Areas or through a State wide collaborative effort, has received funding for participation in the following grant initiatives.

► Green Grant Initiative

Western Virginia CREATES (Construction, Retrofitting, and Energy-Efficiency Assessment Training and Employment Systems) is a regional partnership that was funded through the American Recovery and Reinvestment Act (ARRA) through a U.S. Department of Labor "Energy Training Partnership" grant (award total \$3.8 million) to teach workers the skills required in emerging energy efficiency and renewable energy industries and to connect those workers with employers needing to move their businesses forward in the green economy. This collaborative partnership includes Community Housing Partners, Virginia Tech, NewVA Corridor Technology Council, New River Community College, Wytheville Community College, Virginia Western Community College, New River/Mount Rogers Workforce Investment Board and Virginia Western Workforce Development Board and covers 21 jurisdictions in Southwest Virginia (the counties of Bland, Carroll, Floyd, Giles, Grayson, Montgomery, Pulaski, Smyth, Washington, Wythe, Alleghany, Botetourt, Craig, Roanoke, and Franklin and the cities of Bristol, Galax, Radford, Salem, Roanoke, and Covington). Community Housing Partners is the grant recipient and acts as fiscal agent. Currently the two WIBs are in the process of outreach and taking applications from the unemployed, under-employed and small business owners for program participants (and assessments being done to determine eligibility), equipment is being purchased by the community colleges, new curriculum is being developed between VT and the three community colleges, and outreach to employers is ongoing by all partners. The grant runs January 15, 2010 through January 14, 2012.

► Western Virginia HITE Grant

Western Virginia HITE (Health Information Technology Education) initiative is a regional partnership that was funded through a U.S. Department of Labor "Community-Based Jobs Training" grant (award total \$4.7 million) to provide training opportunities for medical records specialists/health information technicians, medical assistants, pharmacy technicians, licensed practical nursing (LPN) and registered nursing (RN) occupations. The HITE initiative will provide training to incumbent workers, unemployed and under-employed in electronic medical records management through the five community colleges. This collaborative partnership

includes Mountain Empire Community College, Southwest Virginia Community College, New River Community College, Virginia Western Community College, and grant recipient & fiscal agent Virginia Highlands Community College, Southwest Virginia Workforce Board, New River/Mount Rogers Workforce Investment Board, Western Virginia Workforce Development Board, Virginia Tech, University of Virginia's College at Wise, Carilion Clinic, Montgomery Regional Hospital (HCA), Pulaski Community Hospital (HCA), Clinch Valley Medical Center (Lifepoint), Holston Medical Group, Buchanan General Hospital and select locations of Mountain States Health Alliance. HITE covers 29 jurisdictions in Southwest Virginia including the counties of Buchanan, Dickenson, Lee, Russell, Scott, Tazewell, Wise, Bland, Carroll, Floyd, Giles, Grayson, Montgomery, Pulaski, Smyth, Washington, Wythe, Alleghany, Botetourt, Craig, Roanoke, and Franklin and the cities of Norton, Bristol, Galax, Radford, Salem, Roanoke, and Covington. This grant was awarded July 1, 2010. The partners will be scheduling a meeting in the next month to set out the process for implementing this grant.

► **Statewide On the Job Training Grant**

This Statewide collaborative initiative will provide funding of \$1.5 million across the State to support on the job training for displaced workers who are experiencing prolonged unemployment. Participants will be given a chance to "earn and learn" which means they will develop applicable occupational skills while earning a paycheck. Employers participating in this on the job training project will receive partial reimbursement to offset the extraordinary cost of training workers. This project will help workers become proficient in needed skills more quickly, which will serve to encourage employers to hire workers sooner than perhaps initially planned, facilitating the private sector hiring of well-qualified individuals to contribute to their bottom line and spur economic recovery. For further information, please contact Ronnie Martin at (540) 633-6764 or email rmartin@nrpdc.org.

RIDE Solutions

RIDE Solutions welcomes Warm Hearth Village to its Workplace Partner program! Their leadership in recognizing the benefits of commute options available in the region will contribute to cost-savings for their staff, improved air quality, and reduced energy consumption.

Through its Workplace Partner program, RIDE Solutions assists area businesses and organizations with implementing employer-based alternative transportation programs. Working directly with businesses has two impacts on traffic in the region: 1) RIDE Solutions can more easily educate employees about the cost-savings and

environmental benefits of commuting options other than the single-occupant vehicle (SOV) even as little as one day a week and 2) RIDE Solutions reaches an audience with a common destination or employment center, improving their opportunity to find matches for carpooling.

RIDE Solutions also supports its employer partners with promotional materials, contests, communication plans, even bike racks and signage, all free of charge. A complete list of RIDE Solutions Workplaces and more information about the Workplace program can be found at ridesolutions.org/workplace. For more information, please contact Christy Straight, at (540) 639-9313, ext. 209 or cstraight@nrpdc.org.

NRVPDC Commission Meeting Summary

June 24, 2010

EDA Community Trade Adjustment Grant

- Focus on Transportation Industry between Roanoke Region through NRV to Mount Rogers Region
 - Site visit with EDA for 6/25 to discuss grant details; Very positive to receive this much interest in project from EDA; Great collaboration between EDD's/PDC's, VT and Industry (Volvo)

Congressman Boucher Conference: Build Local Economy in Global Market

- July 19, 9:30-1:00, no charge; Southwest Higher Ed Center (Abingdon); Focus on Small Business Development Resources; Register by July 15

Vision 2020/CEDS

- Drafting "Consumer" version of Vision 2020 and will be distributed in draft for review at next meeting

Workforce Investment Board

- Establishing independent agency
 - Previously PDC employees
 - PDC performed all payroll, human resource, and fiscal agent duties for WIB
- Decided on revised agreement
 - Provided clarity on WIB employees=consortium employees
 - Defined responsible parties and illustrated processes
 - Revised agreement to be executed before June 30, 2010

Go Green NRV

- NRVPDC accepted as a Participating Business
- Christy Straight serving on Exec. Comm. as Secretary
- Current Green Practices at NRVPDC: Mixed paper recycling, plastic recycling, composting, calculating carbon footprint, all recyclables are carried off site by staff volunteers

Green Infrastructure Planning

- New website, primarily a resource site: <http://www.nrvpdc.org/GreenInfrastructure/greeninfrastructure.html>; To be launched on PDC website, Monday, 6/28
 - August/September presentation on Green Infrastructure Planning in the NRV

Regional Partnership

- PDC website to host page dedicated to partnership
 - Offer surplus items to other governments/agencies
 - Host 5-year equipment purchase list, identify purchasing partners
 - Adding a widget for notification when items are added to site

VAPDC Summer Conference

- July 29-31 (Thursday-Friday p.m.); Virginia Beach, Cavalier Hotel
- Key Topics: Government Reform, Early Childhood Education, Port of VA Tour - focus statewide, economic development, Governor McDonnell (Keynote Speaker - invited), Secretary of Commerce (Keynote Speaker - confirmed), Secretary of Transportation (Keynote Speaker - confirmed)
- Kevin Byrd nominated to VAPDC Board of Directors

'Round the Mountain

- Total members = 493; 306 artisans; 72 agritourism businesses; 115 craft venues; 378 trail sites in 19 counties
- Trail Brochures: Floyd - complete; Pulaski/Radford - August; Montgomery - August; Giles - Fall

(The July meeting was cancelled)



NRV Economic Indicators

Employment and Wages

The NRV's 4th quarter wage data for 2008 and 2009 shows a decrease in average employment of 3,627 (5.3%) persons. The weekly wage increased (\$22) and the number of establishments decreased (10 or .2%).

AVERAGE EMPLOYMENT		
Jurisdiction	2008 4th Qtr	2009 4th Qtr
Floyd County	2,801	2,740
Giles County	4,827	4,664
Montgomery County	40,537	39,488
Pulaski County	13,401	11,513
Radford City	6,600	6,134
NRVPDC	68,166	64,539

Source: Virginia Employment Commission.

AVERAGE WEEKLY WAGE		
Jurisdiction	2008 4th Qtr	2009 4th Qtr
Floyd County	\$521	\$535
Giles County	650	703
Montgomery County	708	732
Pulaski County	650	633
Radford City	744	791
NRVPDC	688	710

Source: Virginia Employment Commission.

AVERAGE ESTABLISHMENTS		
Jurisdiction	2008 4th Qtr	2009 4th Qtr
Floyd County	381	386
Giles County	363	363
Montgomery County	2,196	2,191
Pulaski County	737	731
Radford City	351	347
NRVPDC	4,028	4,018

Source: Virginia Employment Commission.



Source: Virginia Employment Commission

New Vehicle Registrations

Car and truck registrations increased throughout the District between the 1st and 2nd quarters of 2010. Montgomery County showed the largest increase in car registrations with Pulaski County showing the largest increase in truck registrations, 146 and 13 respectively.

CAR REGISTRATIONS			TRUCK REGISTRATIONS		
Jurisdiction	1st Qtr 2010	2nd Qtr 2010	Jurisdiction	1st Qtr 2010	2nd Qtr 2010
Floyd County	39	85	Floyd County	11	12
Giles County	58	95	Giles County	17	20
Montgomery County	311	457	Montgomery County	63	69
Pulaski County	111	177	Pulaski County	26	39
Radford City	42	75	Radford City	13	6
Total	561	889	Total	130	146

Source: Virginia Automobile Dealers Association.



The next Operation Milestone for the U.S. 2010 Census is **Quality Assurance Operations**. During the next several months, the Census Bureau will conduct three major quality assurance operations and other processes to ensure that the 2010 Census is an accurate and complete picture of everyone living across the nation. These efforts are an investment in the quality of the Census that will pay off for the next 10 years.

Coverage Follow-Up Operation (4/11/10 - 8/13/10) - During this operation, the Census Bureau will call households who have responded to the 2010 Census if they need to clarify any answers about the number of people living at the address on April 1st. **Vacant Delete Check (7/24/10 - 8/25/10)** - They collect additional information to ensure housing units classified as vacant (or nonexistent) were in fact unoccupied on April 1st. **Field Verification (8/6/10 - 9/3/10)** - They send Census workers to verify whether an address exists and to confirm its geographic location, if it does not match an address in their file. Source: <http://2010.census.gov/2010census/how/2010-census-progress.php>.

NRV Transportation News

► The Transportation Technical Advisory Committee is currently reviewing the draft Statewide Rural Long Range Plan technical document. This first round of reviews involves ensuring local and statewide transportation planning efforts are aligned in the plan. Ultimately, the Virginia Department of Transportation seeks local endorsement of the plan and will utilize the document for guidance of future project investments. The plan is currently being reviewed for consistency with local policies and strategies. Public Hearings will also be scheduled in the Fall to collect input on the plan.

► In August the Region's Bikeway Walkway Committee will participate in a joint meeting with the Roanoke Valley Alleghany Regional Commission's Bicycle Advisory Committee. The event will provide a unique opportunity to share local planning efforts and discuss future connections between the regions.

► The City of Radford and Radford University continue to make strides towards the implementation of their new public transportation system. The City was successful in securing federal and state funding to assist with initiating the new services. In the coming months, the City will be advertising for a new service operator, finalizing routes, and branding the new system. A great deal of work lies ahead, but once completed, residents will have a new way to explore, shop, get to work, go to class, visit friends and family, ride to and from doctors offices and medical facilities. For further information on transportation related issues, please contact Elijah Sharp at (540) 639-9313, ext. 210.

August 2010

Meetings

SUN	MON	TUE	WED	THU	FRI	SAT
1	2	3	4	5	6	7
8	9	10	11	12	13	14
15	16	17	18	19	20	21
22	23	24	25	26	27	28
29	30	31				

- Aug. 3-Blacksburg PC-7:30 p.m.
- Aug. 5-MPO Policy Board Meeting-MC Gov't Center-2 p.m.
- Aug. 10-Pulaski PC-7 p.m.
- Aug. 11-Montgomery PC-7 p.m.; NRV Commerce Park-Noon
- Aug. 16-Pulaski Town PC-6 p.m.
- Aug. 17-Floyd PC-7p.m.
- Aug. 18-Montgomery PC-7 p.m.
- Aug. 19-MPO TAC-MC Gov't Center-10 a.m.
- Aug. 20-NRV-Roanoke Joint Bikeway-Walkway Committee-Elliston-1:00-3:30 p.m.
- Aug. 23-Radford PC-7 p.m.
- Aug. 24-Giles PC-6:30 p.m.
- Aug. 26-NRVPDC Commission Mtg.-6 p.m.
- Aug. 31-Hazard Mitigation Mtg.-NRVPDC-9 a.m.

September 2010

Meetings

SUN	MON	TUE	WED	THU	FRI	SAT
			1	2	3	4
5	6	7	8	9	10	11
12	13	14	15	16	17	18
19	20	21	22	23	24	25
26	27	28	29	30		

- Sept. 2-MPO Policy Board Meeting-MC Gov't Center-2 p.m.
- Sept. 7-Blacksburg PC-7:30 p.m.
- Sept. 8-Montgomery PC-7 p.m.
- Sept. 13-Pulaski Town PC-6 p.m.
- Sept. 14-Pulaski PC-7 p.m.
- Sept. 15-Montgomery PC-7 p.m.
- Sept. 16-MPO TAC-MC Gov't Center-10 a.m.
- Sept. 20-Radford PC-7 p.m.
- Sept. 21-BWVW Mtg-NRVPDC-11:30 a.m.; TAC Mtg-NRVPDC-1:30 p.m.; Floyd PC-7p.m.;
- Sept. 23-NRVPDC Commission Mtg.-6 p.m.
- Sept. 28-Hazard Mitigation Mtg.-NRVPDC-9 a.m.; Giles PC-6:30 p.m.

THE COMPETITIVE EDGE

Official Publication of the New River Valley Competitiveness Center
A Small Business Incubator

Shawn Utt/Doug Hudson,
Acting Incubator Managers

August – September 2010

AUR, Inc. keeps things flowing in the NRVCC

How a group of aerospace engineers came upon a breakthrough in protecting the integrity of highway and railway bridge foundations is no mistake, despite the apparent disciplinary disconnect. “Whenever I speak with aerospace engineers about our company’s solution to the bridge scour problem, I always mention the old adage: the mark of a great idea is when you are baffled by the question, ‘why has no one ever thought of this before?’”, says Dr. Todd Lowe, the Vice President for Research and Development at Applied University Research, Inc. (AUR) Lowe’s question is driven largely by his background as an aerodynamicist who is used to seeing complex solutions for air flow problems. Perhaps the truest answer to the question lies in the experience of AUR President, Dr. Roger L. Simpson, a registered Professional Engineer with a background in aerospace and mechanical engineering. As an expert aerodynamicist, Simpson spent years studying and documenting flows with features very similar to those occurring at the bases of bridge piers, and he is recognized in the field as the world’s expert in such ‘junction flows’. The bridge scour problem is one of fluid flow, and understanding this class of flows better than anyone before him gave Simpson the unique vision to solve the problem.

For some background, bridge scour is a potentially catastrophic and deadly phenomenon in which the soil and rock that is used to stabilize the foundations of bridge piers and abutments is moved away from the pier and abutment footings. In extreme cases, sufficient soil and rock can be removed to the extent that the bridge foundation shifts and causes the roadway deck to collapse into the waterway beneath. The problem is a serious risk to public safety and infrastructure, and it is pervasive throughout the U.S. and the world: more than 20,000 bridges in the U.S. alone have been marked by engineers as at risk to scour effects.

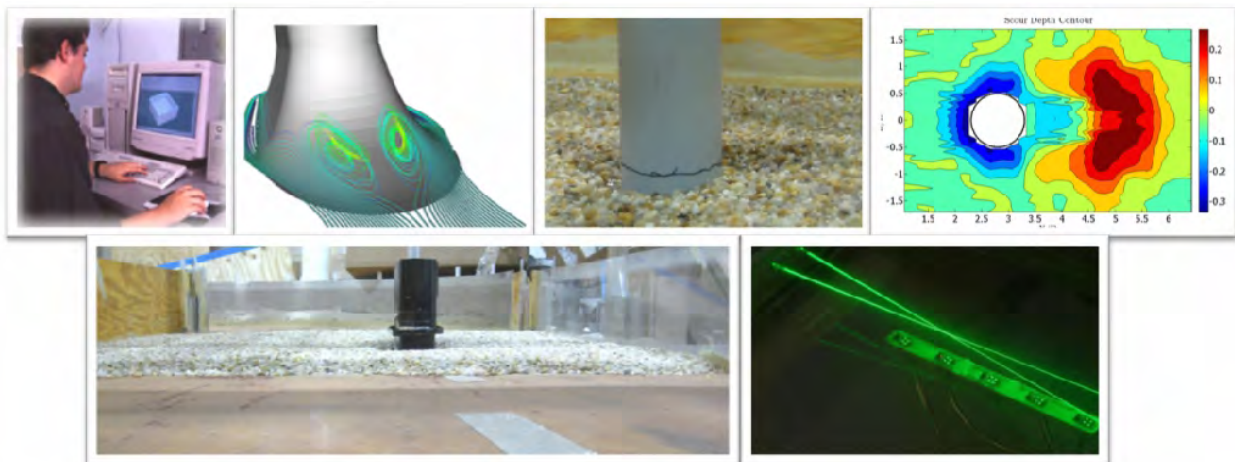

AUR’s bridge scour solution, the scaUR™ product, went through extensive design evaluation, from computer simulations to real flow experimentation using custom developed flow apparatus and laser instruments.

Since moving to the NRVCC in September of 2007, AUR has plotted a steady course toward bringing their bridge scour solution, the Patent Pending scAUR™ device, to market. Dr. Quinn Tian, also with a background in aerospace and mechanical engineering, guided the product development from computer simulations and design to scale water flow testing in AUR facilities at the NRVCC to current developments in efficient manufacturing of the scAUR™ technologies. The company is currently speaking with potential customers across the entire U.S., with plans to extend their reach to Europe and Asia.

When asked about his belief and commitment to this product and its potential to improve the safety of bridges throughout the world, Simpson leaves no doubt as to his stance: “No bridge should ever fail again due to local scour around piers and abutments - if the proper scAUR™ products are installed.” AUR plans to deliver the fruits of that promise of safety and infrastructure protection to many bridges soon.

If you would like to learn more about AUR’s scAUR™ product or its line of laser instrumentation for flow measurement, please visit their websites: <http://www.noscour.com/> and <http://www.aurinc.com/>.

ANNOUNCEMENTS and UPCOMING EVENTS

ENTREPRENEUR EXPRESS: MOVING YOUR BUSINESS FORWARD

You are invited and encouraged to attend the Entrepreneur Express Workshop on Thursday, August 19, 9 a.m. - 12 noon, at the New River Valley Competitiveness Center, in Fairlawn. This workshop is designed to deliver practical, hands-on training and provide information on available business resources. Attendees with specific interests or resource needs will receive follow-up attention from the workshop's sponsoring and participating organizations. They include local, state, and federal resource providers. Workshop participants will be introduced to many potential programs of interest to start-up companies and growing small businesses, from business plan counseling through increasing sales and obtaining financing.

Sponsored by: Pulaski County Chamber of Commerce; Virginia Economic Bridge; Virginia Department of Business Assistance; New River Valley Competitiveness Center; Wachovia Bank.

Admission is **FREE**, including breakfast, but advanced registration is required by August 16th. Register at: www.vastartup.org or call the Pulaski County Chamber of Commerce at (540) 674-1991.

Reserve your spot today for this session. It could make a big difference in your current or planned business.

For Competitiveness Center information contact:
Shawn Utt or Doug Hudson, Acting Incubator Managers
6580 Valley Center Drive, Suite 302, Radford, VA 24141
Phone: 540.633.6730 Fax: 540.633.6768
incubatormanager@nrvc.org or www.nrvc.org/nrvcc.html



New River Valley Planning District Commission
 6580 Valley Center Drive, Suite 124
 Radford, VA 24141

Green Infrastructure Website Update

Jan R. Gilbertson, Newsletter Editor
 jgilbertson@nrvpdc.org

The New River Valley Green Infrastructure Website Update was successful and the site launched in late June. Staff worked together to develop a visually appealing and informative place for interested communities and individuals to access information about this regional project. The new website highlights significant aspects of the overall project,

including the planning process, mapping, conservation strategies or “Best Management Practices”, and contact information for partners and PDC staff. The website also highlights photos taken around the region by PDC staff and friends. In the coming months, as part of the larger initiative, project partners will be going to various elected and

appointed boards throughout the region to share the information developed through this process.

Following these presentations, it is anticipated that the new website will be a place for individuals throughout the community to go to learn more. Please visit the new site at: <http://www.nrvpdc.org/GreenInfrastructure/greeninfrastructure.html>.

For more information on Green Infrastructure, please contact Regina Elsner at relsner@nrvpdc.org, or at (540) 639-9313, ext. 205.



All email addresses for NRVPC staff have changed. They now end in nrvpdc.org. Please change your records accordingly.

Please continue to visit us on the web at www.nrvpdc.org.

New River Valley News & Views



NEW RIVER VALLEY PLANNING DISTRICT COMMISSION

6580 Valley Center Drive, Suite 124, Radford, VA 24141
 Ph: 540.639.9313 | Fax: 540.831.6093 | nrvpdc@nrvpdc.org | www.nrvpdc.org

Inside this issue:

NRVPDC UPDATES	2
NRVPDC COMMISSION MEETING SUMMARIES	3
NRV ECONOMIC INDICATORS	4
NRV TRANSPORTATION NEWS	4
CALENDARS	5
THE COMPETITIVE EDGE	Insert
WATER SUPPLY PLANNING	6



“Increased Utility Service Capacity – Coming Soon to Eastern Pulaski County” in the Spotlight

The Pulaski County Public Service Authority (PSA) is expanding water and sewer service in the eastern part of the county to serve residents and the New River Valley Commerce Park. The project is scheduled to run until September 2012. Construction began September 17, 2010, with five more contracts being advertised for bids this month and awards anticipated in November.

The \$6.4 million project is funded in part by a \$3.1 million grant from the U.S. Economic Development Administration. The project will increase the water and sewer capacity of the New River Valley Commerce Park to 1 million gallons per day (MGD) and allow for an additional 1 MGD of water service in the area. The NRVPDC is assisting the PSA with grant administration, easement acquisition, and environmental clearance.

The environmental review process for this project was uniquely challenging. Coordination and/or approvals were required with nearly a dozen federal, state, and local agencies for issues including the Farmland Preservation Act,

endangered species, and historic sites. NRVPDC staff worked with state and federal agencies for review and approval of the project, coordinating with consultants for specific assessments on further identifying potential impacts and mitigation measures. Because staff are also assisting the PSA with a loan application to USDA Rural Development, environmental clearance also included preparing a full Environmental Report that was approved by Rural Development.



The project team has spent the past year working through the design and review phase of the project. The consulting engineers have prepared plans and specifications for 6 parts of the project: upgrades for pumping at the Commerce Park and at the City of Radford water treatment plant; a 24-inch water line that will cross the New River; a 12-inch water main; a force main for sewer; a new 1 million gallon water storage tank; and water and sewer service lines at the Commerce Park.

About the New River Valley Commerce Park: The Commerce Park is a joint economic development site that would not otherwise be affordable by individual local governments. Increasing the capacity of water and sewer service at the site improves the marketability of the Commerce Park: the more existing infrastructure available that meets a prospect's needs, the more appealing it becomes as a finalist in a very competitive site selection process.

The Commerce Park includes over 900 acres, is immediately adjacent to the New River Valley International Airport where US Customs is providing Port of Entry Services, and is in a suitable location with low potential for natural disaster interruption of business. Participating localities include Counties of Bland, Craig, Giles, Montgomery, Pulaski, and Roanoke, the Cities of Radford and Roanoke, and the Towns of Dublin, Pearisburg, and Pulaski. For further information contact Christy Straight at (540) 639-9313 or cstraight@nrvpdc.org.



NRVPDC Commissioners

- **FLOYD COUNTY**
EVELYN JANNEY
FRED GERALD
- **GILES COUNTY**
RICHARD MCCOY
VACANT
- **MONTGOMERY COUNTY**
ANNETTE PERKINS
JAMES POLITIS
MIKE HARVEY
- **PULASKI COUNTY**
JOSEPH SHEFFEY
DOUG WARREN
- **CITY OF RADFORD**
HELEN HARVEY
TIM COX
- **TOWN OF BLACKSBURG**
DON LANGREHR
HOLLY LESKO, CHAIR
- **TOWN OF CHRISTIANBURG**
HENRY SHOWALTER
SCOTT WEAVER, TREASURER
- **TOWN OF FLOYD**
MIKE PATTON, VICE CHAIR
- **TOWN OF NARROWS**
TOM GARRETT
- **TOWN OF PEARISBURG**
VACANT
- **TOWN OF PULASKI**
LARRY CLEVINGER
MORGAN WELKER
- **TOWN OF RICH CREEK**
VACANT
- **RADFORD UNIVERSITY**
VACANT
- **VIRGINIA TECH**
DAVID DENT
KEVIN SULLIVAN

KEVIN R. BYRD, AICP
 EXECUTIVE DIRECTOR
kbyrd@nrvpdc.org

NRVPDC Updates

Floyd County Comprehensive Plan Update

Floyd County is currently in the process of a Comprehensive Plan update. This update is being completed to reflect changes that have occurred in the County since the last adopted Comprehensive Plan (2002). Focus groups have been held concerning, agriculture, tourism planning, infrastructure, economic development, recreation, wellness, solid waste management, public safety, and housing and human service issues in the County.

Throughout the County community input meetings were held allowing for additional comment. Participation at these meetings was very high, with total community representation estimated above 190 people. With such an amount of comment the Plan will incorporate numerous ideas and issues from the community not reflected in previous Comprehensive Plans. The Plan is currently being drafted with those comments and suggestions received. *For further information, please contact Jack Whitmore at (540) 639-9313, ext. 259.*

Town of Floyd Comprehensive Plan

The Town Plan is currently being drafted with input being derived from Town Council sessions and issues received at the August 12, 2010 Community Input Session at the Jessie Peterman Memorial Library. In addition to those issues information related to Town infrastructure, services and economic profiles are being augmented with County data to provide a comprehensive vision for the Town and County. This plan has been envisioned to be a stand alone plan while simultaneously incorporating into the Floyd County Comprehensive Plan. Additional areas of the plan being investigated include transportation in and around the town and future land use information. *For further information, please contact Jack Whitmore at (540) 639-9313, ext. 259.*

Mobility Management

Before the end of the calendar year, the Mobility Management project will finalize a draft of its Mobility Resource Manual, complete with contact information, background, route/service area maps, and other pertinent mobility information for travelers in the New River Valley. PDC staff have met with local human service and transit providers in order to revise the plan and revisions are currently underway. The PDC also plans to make a second application to the Department of Rail and Public Transit for implementation funds; the grant deadline is February 1, 2011. *For further information, please contact Jennifer Wilsie at (540) 639-9313, ext. 204.*

Pulaski Adult Day Care and Fall Prevention Center

PDC staff have just completed and submitted the first round of activities associated with

DHCD's Planning Grant process in pursuit of funding for an Adult Day Care facility in Pulaski County. These tasks included the creation of a Management Team, an inventory of existing adult day cares in the region, and the surveying of both local employers and citizens to determine need and buy-in. This information was submitted to the state on September 15 and the County should have a response from DHCD within 30 days with comments and next steps. *For further information, please contact Jennifer Wilsie at (540) 639-9313, ext. 204.*

Baskerville Neighborhood Rehabilitation Project

The Baskerville Neighborhood Rehab project is currently working on activities in order to be under contract with the Department of Housing and Community Development (DHCD) by December 1, 2010. The project staff participated in a successful Contract Negotiation meeting with the state in late August and has 90 days to complete tasks such as completing its Environmental Review, gaining Board approval of certain crosscutting state requirements, solidifying its Management Team, and drafting final versions of its Program Design and Management Plan. The Baskerville Rehab project was awarded \$1,000,000 by DHCD earlier in the summer to complete 12 single-family rehabilitations and six substantial reconstructions. *For further information, please contact Jennifer Wilsie at (540) 639-9313, ext. 204.*

HOME

The HOME Consortium has been working with Giles County over the last year in order to plan for their upcoming round of HOME funds, available beginning July 1, 2011. Giles County had delegated project selection responsibilities to its Indoor Plumbing and Rehabilitation (IPR) Board. A letter on behalf of the County had been mailed to each Town advertising the funds and requesting HOME-eligible project submissions. At its August 19 meeting, the IPR voted to commit funds to two projects: an assisted living facility to be partnered with the existing Riverview Nursing Home in Rich Creek, and a mixed-use downtown project for eight rental units in the Town of Narrows. Funding requests for both projects total the County's allocation of \$590,000, and each project is seeking to leverage other funding sources as well. *For further information, please contact Jennifer Wilsie at (540) 639-9313, ext. 204.*

Green Infrastructure

The Green Infrastructure Assessment report is in its final drafting stages. Once it is completed, Committee members will review and provide comments on the draft before it is sent for final printing. The final report should be available in the next several months. Most project information is available on the NRVPDC's Green Infrastructure Website at: <http://www.nrvpdc.org/GreenInfrastructure/>

[greeninfrastructure.html](http://www.nrvpdc.org/GreenInfrastructure/). *For further information, please contact Regina Elsner at (540) 639-9313, ext. 205.*

Hazard Mitigation

The NRVPDC hosted a series of 5 public open houses in September to allow for public comment on the draft mapping for the Hazard Mitigation Plan. At these meetings, a short overview presentation was given and then there was an opportunity for participants to look over all the maps, both regional and locality specific maps. During that time, PDC staff was available to answer questions and receive any comments to incorporate into the mapping and draft plan.

The draft maps are available on the NRVPDC Hazard Mitigation project website at: <http://www.nrvpdc.org/HazardMitigation/HazardMitigationPlanning.html>. Additional sections of the plan will be made available on this site once they are drafted and reviewed. The draft plan should be completed and available for public review by the end of October. *For more information on Hazard Mitigation Planning, please contact Regina Elsner or Christy Straight at (540) 639-9313.*

New River/Mount Rogers

Workforce Investment Board (WIB)

The Western Virginia CREATES (Construction, Retrofitting and Energy Efficiency Assessment Training and Employment Systems) regional grant program that the New River/Mount Rogers Workforce Investment Board is in regional partnership with multiple agencies has gotten off to a very fast and successful start.

The CREATES program began to be publicized in June, with radio spots, newspaper articles and promotional flyers. An open house was held at New River Community College and on-site visits were made to VEC offices and One-Stop Centers throughout the thirteen jurisdictions covered by the grant. By the beginning of July, interest and activity increased quickly. Rhonda Womble, the program specialist for the CREATES program, spent one day a week at both New River Community College in Dublin and Wytheville Community College/Crossroads Institute in Galax, speaking to classes, interviewing applicants and administering Career Scores, (one of two assessments required for eligibility). In August, the pace increased even more as fall semester deadlines approached.

Currently, there are 75 applicants in the process of becoming eligible for the program. Funding authorizations for full tuition and up to \$400 in supportive services are issued directly to the training institutions.

A portion of the grant has allowed community colleges to develop alternative energy curriculums and expand their solar photovoltaic and wind turbine equipment, providing hands-on training. Program offerings include

everything from a one day contractor's license exam prep class to a two-year program to become a solar installer. In addition to the alternative energy classes, there are also one and two year programs in electrical engineering, carpentry and heating/air conditioning. Periodically, a shorter one-year alternative energy Career Studies Certificate may be imbedded within an existing engineering degree so that the student will graduate with that "green shell" on his trade degree. Classes in Lead Safety are proving to be a lifeline to those small contractors who must meet the federally mandated certification requirement coming up in April of 2011. The New River Center for Energy Research and Training offers the BPI credentials; a nationally recognized certification of the Building Professional Institute, which appeals to those who have been working in the field for several years and are looking to add knowledge of alternative energy practices. The CREATES program currently has 66 students in training in the three schools.

Since the beginning of fall semester, the focus has widened to include meetings with employers to not only enroll their staff in one of the programs, but also to cultivate future jobs for CREATES graduates. High levels of interest in the CREATES program continues, with applicants now being enrolled for the spring semesters.

The intent of the CREATES program is not only to provide tuition for training, but to also assist in job search. Employer outreach is a large part of the current activity including on-site visits, speaking engagements at area business organizations and the formulation of a green job fair to be held in Roanoke in December 2010. CREATES has 39 individuals that have completed training and are currently employed. For further information, please contact Ronnie Martin at (540) 633-6764 or email rmartin@nrvc.org.

Attention All Local Planning Commissions in the NRV

The 23rd Annual Dinner Meeting of the Local Planning Commissions in the New River Valley will be held on **Thursday, October 28, 2010**, at the German Club in Blacksburg. The speaker will be Denise Barrett, Executive Director of Appalachian Sustainable Development. She will be discussing Local/Regional Food Systems Planning. The co-host for this event is the Town of Blacksburg. For further information, contact Anne McClung at (540) 961-1183, amcclung@blacksburg.gov.

NRVPDC Commission Meeting Summaries

August 26, 2010

EDA Community Trade Adjustment Grant

- Site visit with EDA on 7/21 to discuss grant details
- Received non-binding letter of commitment - \$1,499,000
- \$175,000 match provided by Volvo (industrial engineer time)
- Volvo hosted dynamic site visit and plant tour
- Great collaboration between EDD's/PDC's, VT and Industry (Volvo)

New River Valley Network Wireless Authority (NRVNA)

- \$9.2 million in grant funds announced
- Citizens lead with RRVNA support
- \$800,000+ matching funds from RRVNA
- Open access points for private sector ISPs to further develop last mile service for residents

Sustainable Communities Grant Application

- Submitted August 23rd; significant regional undertaking
- Proposal to create NRV Regional Plan for Sustainable Development—"Sustainability Hubs" focus on affordable housing-Match from ARC, EDA, HOME Consortium (B'burg)
- Integrate: Transportation, Food Systems, Infrastructure, Information Technology, Cultural Heritage, Energy, Natural Resources, Economic Development
- Requested \$1,000,000 in grant funds
- MOU Signatories: Floyd, Giles, Montgomery, Pulaski Counties/City of Radford, Blacksburg, Christiansburg, Virginia Tech, Community Foundation for the New River, Community Housing Partners, New River Community Action, MPO and National Committee for the New River

VAPDC Summer Conference

- Smart Beginnings - Richmond Regional Collaborative-Early Childhood Education - prenatal to 5 years old; Preparing children for Kindergarten; Public/Private Initiative; Alarming statistics document need for early childhood education; New River Valley Smart Beginnings taking shape-Business Leaders Breakfast - NRV Kick-off-September 30th, 7:30 a.m., Inn at VT
- Port of Virginia Tour-Highlighted importance of Port to statewide economy; Potential to become the most significant port on east coast; 350,000 jobs associated with port industries; Average \$70,000 wage
- Port acquired 20 year lease on APM facility-Newest shipping facility in western hemisphere; Will allow for equal footing with Port of NY
- Working on Legislative Focus for VAPDC-New leadership on VAPDC legislative committee; May engage services to fully develop VAPDC legislative strategy
- EDA Meeting- Issues with PDC Board composition; CEDS Committee to be established; Need to engage private sector/universities in NRV

September 23, 2010

New Commissioner Orientation

- Held September 20th-Attended by: Tim Cox, City of Radford; Doug Warren, Pulaski County; Morgan Welker, Pulaski Town
- Overview of PDC purpose and Commissioner roles; Discussed communication between PDC and localities; Encouraged taking advantage of regional forum offered by Commission meetings

Secretary of Transportation Visit

- September 1, hosted by VTTI-Open Forum: Secretary shared the Administration's perspectives, attendees offered suggestions; Detailed discussion during visit on how VDOT receives feedback for programming Six-Year Plan
- PDCs are currently being surveyed by JLARC to understand role in state programming

Rural Transportation Program Updates

- Rural Long Range Plan currently being reviewed by staff at local governments in the region
- Public input anticipated in November; VDOT is determining local government endorsement level; Desire a direct connection between Plan and programming decisions
- Bikeway-Walkway Committee working to notify everyone that Bike Virginia is coming to NRV in 2011; Future of Passenger Rail Presentation by DRPT: October 27, 5:30-7:00, O. Winston Link Museum, Roanoke
- Governor's Transportation Conference, December 8-10, Hotel Roanoke, "Reforming and Revitalizing Transportation in Virginia"



NRV Economic Indicators

2008 % Living in Poverty	11.9%	12.9%	11.4%	12.5%	20.6%	15.4%	26.7%	17.4%	10.2%
2007 % Living in Poverty	12.9%	11.4%	19.9%	14.1%	30.9%	17.8%	9.9%		
2000 - % of Population (16 & over) not in Labor Force	38.6%	41.9%	41.0%	39.3%	46.2%	50.9%			
Avg. Unemployment for last 6 months	8.0%	9.7%	7.7%	10.1%	10.1%	8.6%	7.2%		
July 2010 Unemployment	7.8%	8.9%	7.8%	9.1%	10.7%	8.5%	7.1%		
2009 Annualized Unemployment	7.8%	9.2%	6.7%	11.1%	8.6%	8.7%	6.7%		
2008 Annualized Unemployment	4.4%	6.5%	4.1%	6.6%	5.3%	4.9%	4.0%		
Qtr 1 2010 Avg. Weekly Wage	\$ 475	\$ 703	\$ 662	\$ 672	\$ 709	\$ 622	\$ 932		
Difference from State Average	\$ -435	\$ 252	\$ 234	\$ 325	\$ 187	\$ 287	\$ 928		
2009 Avg. Weekly Wage	\$ 493	\$ 676	\$ 694	\$ 603	\$ 741	\$ 641	\$ 928		
Difference from State Average	\$ 19,896	\$ 17,888	\$ 18,034	\$ 20,784	\$ 25,694	\$ 20,419	\$ 1,636		
Median Household Dollar Change	\$ 2,136	\$ 2,136	\$ 1,147	\$ (1)	\$ 2,504	\$ 1,564	\$ 1,636		
2008 Median Household Income	\$ 41,614	\$ 43,322	\$ 43,176	\$ 40,426	\$ 35,616	\$ 40,791	\$ 61,210		
2007 Median Household Income	\$ 39,378	\$ 41,186	\$ 42,029	\$ 40,427	\$ 33,012	\$ 39,206	\$ 59,576		
Per Capita Dollar Change	\$ 2,232	\$ 2,612	\$ 3,129	\$ 2,666	\$ 3,129	\$ 2,763	\$ 4,636		
2008 Per Capita Annual Personal Income	\$ 26,609	\$ 27,594	\$ 27,102	\$ 31,813	\$ 27,102	\$ 28,050	\$ 44,076		
2006 Per Capita Annual Personal Income	\$ 24,277	\$ 24,992	\$ 23,973	\$ 29,228	\$ 23,973	\$ 26,287	\$ 39,540		
% of WIA population by Jurisdiction	8.9%	9.6%	52.9%	19.8%	8.8%				
Est. Population Change from 2000 to 2009	11.1%	-0.1%	9.3%	-2.7%	-4.5%	-4.4%	11.4%		
Provisional 2009	15,418	16,648	91,395	34,167	15,162	172,780	7,882,590		
Final 2008 Population	16,173	16,444	90,724	34,409	15,536	172,286	7,795,424		
2000 Census Count	13,874	16,657	83,629	35,127	15,859	165,421	7,079,030		
Jurisdiction	Floyd County	Giles County	Montgomery County	Pulaski County	City of Radford	NRV Planning Dist.*	Virginia		

Source: US Census, Weldon Cooper Center, Bureau of Labor Statistics, Bureau of Economic Analysis, and the Virginia Workforce Connection
 * some numbers are an average
 Courtesy of the New River/Mount Rogers Workforce Investment Board (nmwib.org)

Taxable Sales

The dollar amount of taxable sales increased throughout the NRV jurisdictions between the 1st and 2nd quarters of 2010. Pulaski County showed the largest increase (\$7,062,221) while the City of Radford showed the smallest increase (\$1,325,492).

TAXABLE SALES		
Jurisdiction	2010 1st Qtr	2010 2nd Qtr
Floyd County	11,242,311	14,157,222
Giles County	27,270,886	31,297,129
Montgomery County	213,039,055	216,152,419
Pulaski County	67,143,417	74,205,638
Radford City	16,641,976	17,967,468

Source: Virginia Department of Taxation.

NRV Transportation News

- Sustainability! Livability! New guidance at the federal level for new transportation projects challenges local governments to think outside of the box during fiscal constraints. At the recent Tools of the Trade Conference in Williamsburg, Virginia, small Metropolitan Planning Organizations (MPO's) and Rural Planning Organizations (RPO's), and PDCs were told sustainable and livable communities were all about developing practical solutions. Although the ideas may not be new to planning departments across the nation, the phrases are certainly playing a major role in breaking down traditional funding silos. Partnerships between federal agencies such as the Federal Highway Administration (FHWA), Department of Housing and Urban Development (HUD), and the Environmental Protection Agency (EPA) are bringing communities together across the nation to think about how each planning area impacts the others. The New River Valley participated in such an undertaking by recently applying for a Sustainable Communities Grant. Whether or not funding is granted, the opportunity will have a positive impact on future planning in the NRV.
- The Transportation Technical Advisory Committee continues to work on the Statewide 2035 Rural Long-Range Plan. This initiative has been ongoing for over four years and is led by the Virginia Department of Transportation. Once the plan is completed it will reflect a compilation of statewide and local planning efforts. The plan has provided an opportunity to have a consulting engineering firm make a detailed evaluation of safety and congestion hot spots. The draft plan should be compiled before the end of the year and public meetings will follow allowing appropriate time for public input.
- The Bikeway-Walkway Committee met on the 21st of September to review draft mapping for the Bikeway-Walkway-Blueway Plan. Data collection has been ongoing for nearly one year to update the plan that was adopted in 2000. Many trails are being mapped and made available to the public for the first time. Other existing trails are being mapped to include interactive information for trail users. The draft plan is scheduled to be completed for committee review by the end of the year. For further information on transportation related issues, please contact Elijah Sharp at (540) 639-9313, ext. 210.

October 2010

Meetings

SUN	MON	TUE	WED	THU	FRI	SAT
					1	2
3	4	5	6	7	8	9
10	11 <i>Columbus Day</i>	12	13	14	15	16
17	18	19	20	21	22	23
24/31	25	26	27	28	29	30

- Oct. 5-Blacksburg PC-7:30 p.m.
- Oct. 7-MPO Policy Board Meeting-MC Gov't Center-2 p.m.
- Oct. 12-Pulaski Town PC-6 p.m.; Pulaski PC-7 p.m.
- Oct. 13-Montgomery PC-7 p.m.; NRV Commerce Park-Noon
- Oct. 18-Radford PC-7 p.m.; CTB Representative Mtg-9 a.m.-3 p.m.-NRVPDC
- Oct. 19-Floyd PC-7p.m.
- Oct. 20-Montgomery PC-7 p.m.
- Oct. 21-MPO TAC-MC Gov't Center-10 a.m.
- Oct. 25-Pearisburg PC-7 p.m.
- Oct. 26-Giles PC-6:30 p.m.; Hazard Mitigation Mtg.-NRVPDC-9 a.m.
- Oct. 27-Future of Passenger Rail in Western VA Town Meeting-O. Winston Link Museum-Roanoke-5:30 p.m.
- Oct. 28-NRVPDC Commission Mtg.-5:30 p.m. and Local Planning Commission Dinner-German Club, Blacksburg-7:00 p.m.

November 2010

Meetings

SUN	MON	TUE	WED	THU	FRI	SAT
	1	2 <i>Election Day</i>	3	4	5	6
7	8	9	10	11 <i>Veterans Day</i>	12	13
14	15	16	17	18	19	20
21	22	23	24	25 <i>Thanksgiving</i>	26	27
28	29	30	31			

- Nov. 3-Blacksburg PC-7:30 p.m.
- Nov. 4-MPO Policy Board Meeting-MC Gov't Center-2 p.m.
- Nov. 8-Pulaski Town PC-6 p.m.
- Nov. 9-Pulaski PC-7 p.m.
- Nov. 10-Montgomery PC-7 p.m.; NRV Commerce Park-4 p.m.
- Nov. 15-Radford PC-7 p.m.
- Nov. 16-BWVW Mtg-NRVPDC-11:30 a.m.; TAC Mtg-NRVPDC-1:30 p.m.; Floyd PC-7p.m.;
- Nov. 17-Montgomery PC-7 p.m.
- Nov.18-MPO TAC-MC Gov't Center-10 a.m.
- Nov. 22-Pearisburg PC-7 p.m.
- Nov. 23-Giles PC-6:30 p.m.
- Nov. 30-Hazard Mitigation Mtg.-NRVPDC-9 a.m.

THE COMPETITIVE EDGE

Official Publication of the New River Valley Competitiveness Center
A Small Business Incubator

Shawn Utt/Doug Hudson,
Acting Incubator Managers

October – November 2010

MMDS MOBILE X-RAY *“Bringing Healthcare to the Patient”*

MMDS NRV, Mobile Medical Diagnostic Service New River Valley, LLC, a tenant of the Competitiveness Center since 2005, provides diagnostic x-rays for patients in a variety of settings and locations throughout West Central Virginia, hence the “mobile” aspect of the business. As Leigh-Anne Cumbee, Vice President and Chief Operating Officer, indicates, “For most of our clients, remaining in comfortable, familiar surroundings is paramount for their health, safety, and well-being. Research has shown that patients, families and medical caregivers alike, list the difficulties associated with dislocating patients, as a major problem, and that is where we come in...!” In addition to this trauma, there is the increased risk of causing additional medical complications, especially since many geriatric patients are more fragile and prone to injury.

The President and CEO, S. Quentin “Skip” Castle related that “Our number one priority is the health and welfare of the patient. MMDS personnel take great pride in offering quality radiologic studies, and we are especially proud of the fact we are providing the best patient care possible each time we perform a procedure.” Ms. Cumbee reiterated that, “Our technologists are chosen in part based on their sincere interest in providing quality care to their patients. Each technologist is responsible for a particular group of clients/facilities, with whom they become familiar and develop a close working relationship. Together, they ensure patients receive the highest quality care possible!”

The goal of MMDS is to make a difference in patient care and healthcare for everyone they come in contact with. The benefits of their service and the efforts of their staff are evident by the response of the patients and their family members. The President offered these remarks...“We find that our Patients love us...their Families love us, the Nursing Homes find our services very beneficial and we complement their offering of service to their clientele...! Often we get reports of elderly patients crying when they see us...so happy because as they say...I don’t have to go to the hospital now that you are here! That transport to the hospital, the not so stylish open back drafty gown and the whole ordeal is just plain exhausting and stressful on these oftentimes very fragile people! I am proud to say, we eliminate all of that...!” He went on to say that frequently after discovering what MMDS does that the family members say they wish they had known about us sooner, i.e., when their grandmother, grandfather or a parent needed an x-ray while in the Nursing Home or while confined to a bed at home.



You might surmise from all this that Skip and Leigh-Anne sincerely enjoy bringing their services to patients and facilities in the New River and Greater Roanoke Valleys!

For questions regarding their service call the main office at 540.633.6760. They are here to serve You and the Community!

NRV Competitiveness Center Welcomes New Tenant

This past July, Brian Bishop, with Horace Mann Insurance, joined the Center as a tenant. Horace Mann Insurance was founded in 1945 by a group of educators and is the largest multi-line insurance company that focuses on the education community. Bishop Insurance recently opened and became an agent with Horace Mann. When asked exactly what services he offers, Brian explains that he “provides retirement planning as well as auto and life insurance. Educators are our primary market, but we also provide the same quality services to non Educators as well.” Brian is a resident of Pulaski County with his wife Kelly and daughter Caroline. Please contact him at Brian.Bishop@horacemann.com or 540.267.3012.



NRV Competitiveness Center Hosts Delegates from World Bank

Recently, delegates from the World Bank visited the New River Valley and the Competitiveness Center. Thanks to a program through Virginia Tech’s Career & Technical Education program through its School of Education, Dr. Bill Price hosted a group from the World Bank’s Department of Human Development. The goal of the visit was to learn about innovative programs focused on increasing entrepreneurialism and learning how to replicate them throughout the Third World Countries. The group also heard from John Olver, President/CEO of Center tenant Emissshield on his experiences with the incubator system as well as colleagues from Beans & Rice, Inc. (Eric Bucey, Program Manager; Mike Forrest and Sam Hensley) to discuss their MicroSolutions Revolving Loan Fund Program. A special thank you goes out to all who participated and especially to Dr. Price for bringing the group to the Center.

Condolences...

Mary Holliman, a member of the New River Valley Development Corporation Board, passed away on August 13, 2010. Ms. Holliman represented the Town of Blacksburg and was an active member of her community. She was devoted to her hometown of Blacksburg where she served on the Town Council and Town Planning Commission and was active in local civic organizations. Ms. Holliman was a valuable and dedicated member of the Development Corporation for two years. She will be missed and our condolences go out to her family, friends, and her community.

For Competitiveness Center information contact:

Shawn Utt or Doug Hudson, Acting Incubator Managers
6580 Valley Center Drive, Suite 302, Radford, VA 24141
Phone: 540.633.6730 Fax: 540.633.6768
incubatormanager@nrvdc.org or www.nrvdc.org/nrvcc.html



New River Valley Planning District Commission
6580 Valley Center Drive, Suite 124
Radford, VA 24141

Water Supply Planning

Jan R. Gilbertson, Newsletter Editor
jgilbertson@nrpdc.org

The New River Valley Water Supply Plan is scheduled for completion one year ahead of the 2011 regulation deadline for regional plans.

The Regional Water Supply Plan has been approved by the Department of Environmental Quality to move forward to adoption. The NRVPC will be working with all participating localities in the next several months to get the plan adopted by

Boards of Supervisors, City Council, and Town Councils. A full revised version of the plan is available at: <http://www.nrvpdc.org/watersupply.html>. It is anticipated that the plan and associated drought ordinance will be adopted by the end of the calendar year.

On September 24, 2010, the NRVPC gave a presentation on the lessons learned from this water supply planning process with other planners from

across Virginia at the Virginia APA Fall Symposium. For more information on this symposium, the NRVPC presentation, and Virginia APA please visit: <http://apavirginia.org/member-resources/conferences/fall-2010-symposium>.

For more information on Water Supply Planning, please contact Regina Elsner at relsner@nrpdc.org, or at (540) 639-9313, ext. 205.

All email addresses for NRVPC staff have changed. They now end in [nrpdc.org](mailto:@nrpdc.org). Please change your records accordingly. Please continue to visit us on the web at www.nrvpdc.org.